

Spout  
4/1/14  
miller

# KRUPS

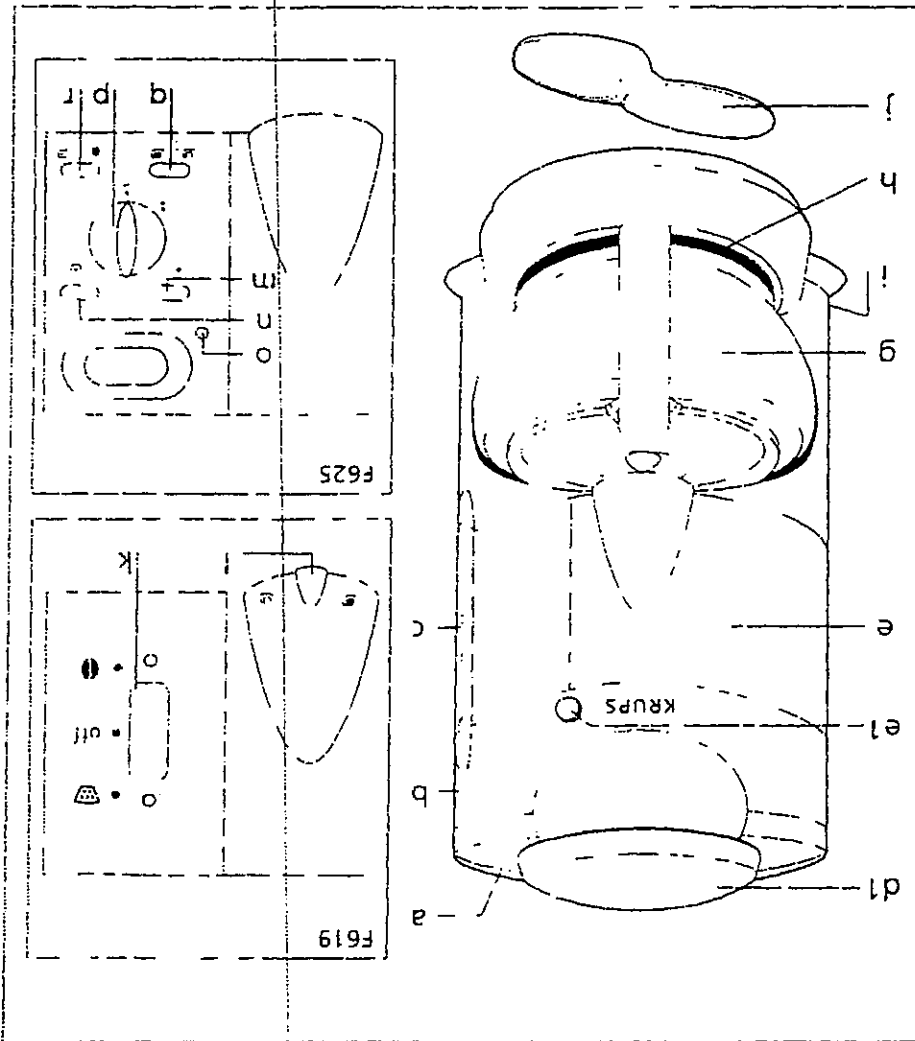
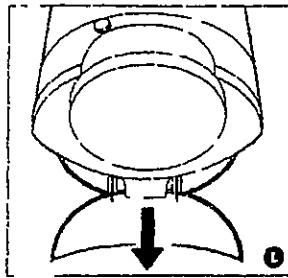
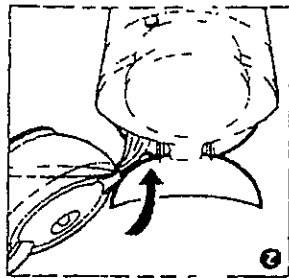
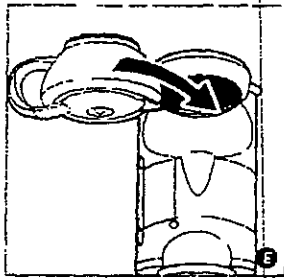

# 625

REPRODUCED FROM THE ORIGINAL DRAWING BY THE NATIONAL ARCHIVES

# KRUPS

FreshAroma  
 FreshAroma Time Art F619  
 Art F625

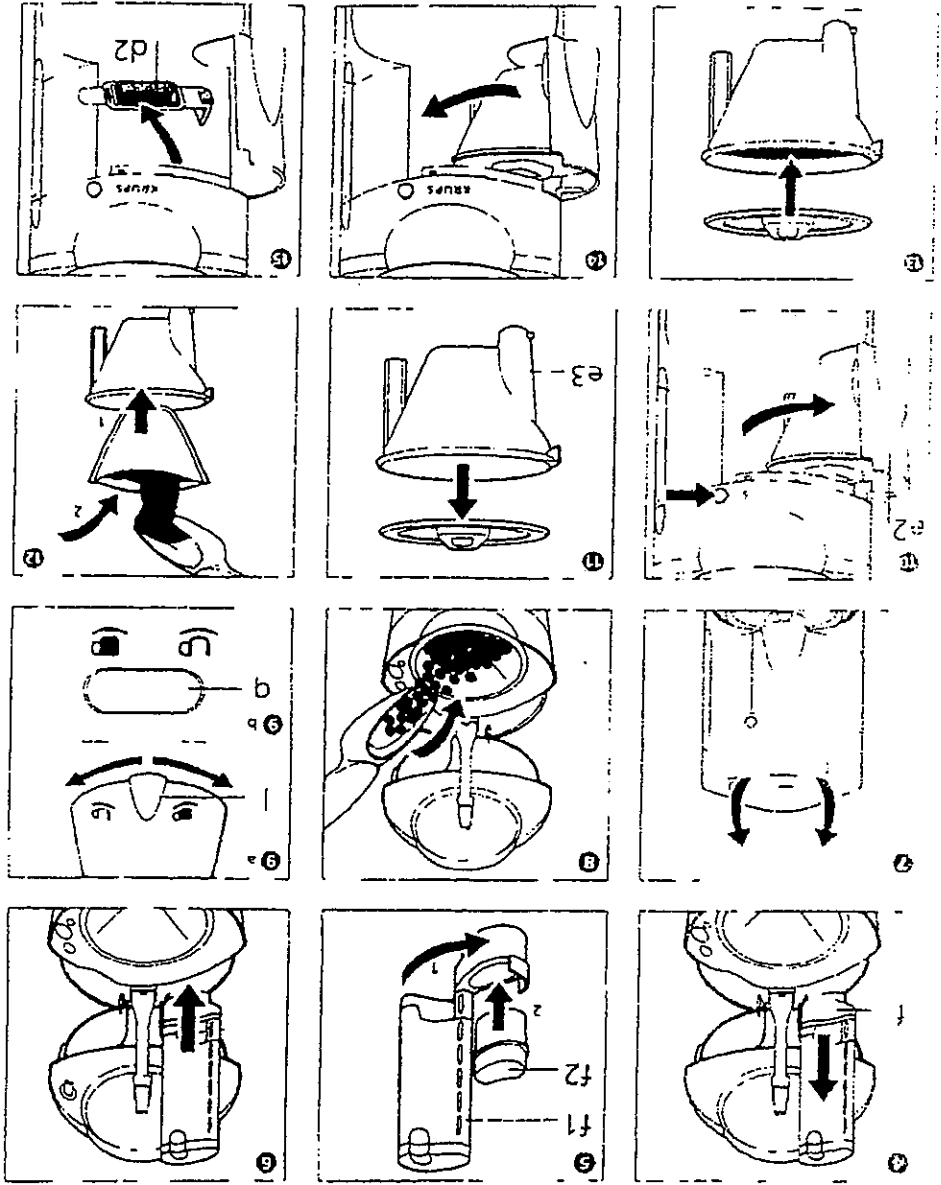

KRUPS

**Description**

a	Water tank cover
b	Water tank
c	Water level indicator
d	Coffee grinder
d1	Cover
d2	Removable coffee ground strength selector
e	Filter holder
e1	Opening button
e2	Filter holder housing
e3	Removable coffee filter holder with cover
f	Duo filter
f1	Plastic filter holder
f2	Duo filter anti-chlorine scale filter
g	Carafe
h	Warning plate
i	Cord storage
j	Measuring scale
<b>Model 619 only:</b>	
k	3 position selector with indicator lights
	Operation with ground coffee
	off stop
	Operation with coffee beans
l	Two position coffee strength selector
	strong or light
<b>Model 625 only:</b>	
m	Hour setting key
n	Minute setting key
o	Indicator light
p	Rotary selector switch
q	Two position coffee strength selector
	strong or light
r	Function selection switch
	beans ground coffee

**Before first use**

Setting the time (model #525)  
 Plug in the KUPS FreshTime  
 Make sure the selector switch (p) is in the  
 off position  
 The LCD display will be flashing intermittently  
 This is your signal to set the digital clock  
 Turn the selector switch to position (p) and  
 set the hours and minutes by pressing the  
 min and max buttons respectively  
 Turn back the selector (p) to the off  
 position  
 The time is now set

**Running with water only**  
 Before making your first pot of delicious  
 coffee we recommend operating the coffee  
 maker once or twice with water only without  
 the use of beans ground coffee or the Duo  
 filter to remove any dust or factory sediment  
 Open the hinged lid (1) using the glass  
 carafe pour in the desired quantity of cold  
 water (2)

Replace the glass carafe on the warming  
 plate with the lid in position (3)

On model 619 set the switch (k) to the  
 ground coffee position

On model 625 set the switch (l) to the  
 ground coffee position and turn the  
 selector switch (p) to the «on» position

**Inserting the "Duo filter"**  
 After rinsing is complete the Duo filter should  
 be inserted

Remove the Duo filter (f) from its plastic  
 bag, rinse in tap water

Open the hinged lid of the coffee maker and  
 remove the Duo filter holder (4)

Place the lower part of the holder and insert  
 the Duo filter into its housing (5)

Replace the holder in the coffee maker and  
 your machine is now ready for use (6)

- On model 619 set the switch (k) to the coffee beans position (1)
  - On model 625 set the switch (r) to the coffee beans position (1) and turn the coffee beans position (1) to the «on» position
  - The indicator light comes on
  - The coffee grinder starts operating with the ground coffee falls directly into the filter. The grinder is rinsed and cleaned automatically as your coffee is prepared
- Using ground coffee**
- Open the filter holder by pressing the button (e1) and swinging it open (10)
  - Remove the filter holder cover (11)
  - (If Gold Tone Filter is not included with machine)
  - Place a No. 4 (1X4) paper filter in the holder
  - Fold back the edges of the paper filter to facilitate closing
  - Pour the required quantity of coffee grounds into the filter using the measuring scoop (12)
  - Note: One measuring scoop corresponds to 1 cup of coffee
  - The maximum quantity is 10 cups
  - Put the filter holder cover back (13)
  - Close the filter holder and make sure that it snaps into place (14)
  - Place the carafe with its cover properly on the warming plate of the coffee machine (3)
  - Check that the cover of the coffee grinder is locked
  - Using the strength selector you can select strong or mild coffee (l) on model 619 (9a) or (q) on model 625 (9b)
  - On model 619 set the switch (k) to the ground coffee position (2)
  - On model 625 set the switch (r) to the ground coffee position (2) and turn the selector (p) to the «on» position
  - The indicator light comes on and your coffee is prepared

- Preparing Coffee**
- Open the hinged lid (1). Using the glass carafe pour in the required quantity of cold water (2). The water level indicator (c) shows how much water you are filling into the carafe.
- The amount of freshly brewed coffee delivered after the brewing process will always be slightly less than the amount put into the water container. This is due to the minimum absorption of the water by the ground coffee. Therefore it is recommended that you add a little extra water at the beginning so that you will have the number of cups you desire.
- Replace the glass carafe on the warming plate with the lid in position (3)
- Using whole coffee beans**
- (7) Open the cover (1) of the coffee grinder
  - Using the measuring scoop (1) pour the required quantity of coffee beans directly into the coffee grinder (8)
  - Note: One measuring scoop corresponds to 1 cup of coffee
  - The maximum quantity is 10 cups
  - Close the cover of the coffee grinder (if Gold Tone Filter is not included with machine)
  - Open the filter holder by pressing the button (e1) (10) and swing it
  - Remove the filter holder cover (11)
  - Place a No. 4 (1X4) paper filter in the holder
  - Fold back the edges of the paper filter to facilitate closing
  - Put the filter holder cover back (13)
  - Close the filter holder and make sure that it snaps into place (14)
  - Place the carafe with its cover properly on the warming plate of the coffee machine (3)
  - Check that the cover of the coffee grinder is locked
  - Using the strength selector you can select strong or mild coffee (l) on model 619 (9a) or (q) on model 625 (9b)
  - On model 619 set the switch (k) to the ground coffee position (2)
  - On model 625 set the switch (r) to the ground coffee position (2) and turn the selector (p) to the «on» position
  - The indicator light comes on and your coffee is prepared

**Preparing Coffee**

5

Place whole beans inside the coffee grinder (B) or ground coffee in the filter (12) and set the warming plate

Fill the water chamber to the desired number of cups. Place the carafe back on the warming plate

• Turn the selector switch (p) to the Prog Setting. The LCD display will flash intermittently. Set the hour and minutes in which you would like the brewing process to commence by pressing the h and m buttons respectively

• First set the digital clock (see Setting the time) • Turn the selector switch (p) to the Prog Setting the extended period of time. Setting the

• This feature enables you to enjoy freshly brewed coffee at any pre selected time within a 24 hour period

Preparing "Wake Up coffee (model #625) This feature enables you to enjoy freshly brewed coffee at any pre selected time within a 24 hour period

• If the machine will not be in use for an extended period of time, rinse the Duo filter with running water and clean the coffee maker

• Only use drinking water with the Duo filter

• You can purchase the DuoFilter (Model # 172) at your local KRUPS retailer or by calling KRUPS Consumer Service Department at 1-800-526-5877, 24 hours a day, 7 days a week (U.S. residents only)

• If the machine will not be in use for an extended period of time, rinse the Duo filter with running water and clean the coffee maker

• Only use drinking water with the Duo filter

• You can purchase the DuoFilter (Model # 172) at your local KRUPS retailer or by calling KRUPS Consumer Service Department at 1-800-526-5877, 24 hours a day, 7 days a week (U.S. residents only)

• If the machine will not be in use for an extended period of time, rinse the Duo filter with running water and clean the coffee maker

• Only use drinking water with the Duo filter

• You can purchase the DuoFilter (Model # 172) at your local KRUPS retailer or by calling KRUPS Consumer Service Department at 1-800-526-5877, 24 hours a day, 7 days a week (U.S. residents only)

• If the machine will not be in use for an extended period of time, rinse the Duo filter with running water and clean the coffee maker

• Only use drinking water with the Duo filter

• You can purchase the DuoFilter (Model # 172) at your local KRUPS retailer or by calling KRUPS Consumer Service Department at 1-800-526-5877, 24 hours a day, 7 days a week (U.S. residents only)

• If the machine will not be in use for an extended period of time, rinse the Duo filter with running water and clean the coffee maker

• Only use drinking water with the Duo filter

• Turn the selector switch to the Auto setting. Wake Up time is now set and the indicator light (o) will illuminate in green

• At the pre-programmed time the indicator light will illuminate in red indicating that the brewing process has begun

• Note: If the selector switch is left in the auto position the coffee maker will turn itself on everyday at the pre programmed time. If you do not wish for this to occur turn the coffee maker to the off position after each use

• The Stop n Serve feature is for a quick cup of coffee. This device returns to the impatient coffee drinker's answer

• The Stop n Serve feature is for a quick cup of coffee. This device returns to the impatient coffee drinker's answer

• The Stop n Serve feature is for a quick cup of coffee. This device returns to the impatient coffee drinker's answer

• The Stop n Serve feature is for a quick cup of coffee. This device returns to the impatient coffee drinker's answer

• The Stop n Serve feature is for a quick cup of coffee. This device returns to the impatient coffee drinker's answer

• The Stop n Serve feature is for a quick cup of coffee. This device returns to the impatient coffee drinker's answer

• The Stop n Serve feature is for a quick cup of coffee. This device returns to the impatient coffee drinker's answer

• The Stop n Serve feature is for a quick cup of coffee. This device returns to the impatient coffee drinker's answer

• The Stop n Serve feature is for a quick cup of coffee. This device returns to the impatient coffee drinker's answer

• The Stop n Serve feature is for a quick cup of coffee. This device returns to the impatient coffee drinker's answer

• The Stop n Serve feature is for a quick cup of coffee. This device returns to the impatient coffee drinker's answer

• The Stop n Serve feature is for a quick cup of coffee. This device returns to the impatient coffee drinker's answer

• The Stop n Serve feature is for a quick cup of coffee. This device returns to the impatient coffee drinker's answer

• The Stop n Serve feature is for a quick cup of coffee. This device returns to the impatient coffee drinker's answer

• The Stop n Serve feature is for a quick cup of coffee. This device returns to the impatient coffee drinker's answer

• The Stop n Serve feature is for a quick cup of coffee. This device returns to the impatient coffee drinker's answer

• The Stop n Serve feature is for a quick cup of coffee. This device returns to the impatient coffee drinker's answer

Maintenance

Replacing the Duo Filter

It is recommended that you replace the Duo filter at least once every 3 months

To replace the Duo filter see inserting the Duo filter in the Before First Use section

If you think your coffee may have will be used over a long period (during water for example) use the Duo filter and clean the machine thoroughly

before putting it away

Important

You can purchase the DuoFilter (Model # 172) at your local KRUPS retailer or by calling KRUPS Consumer Service Department at 1-800-526-5877, 24 hours a day, 7 days a week (U.S. residents only)

If the machine will not be in use for an extended period of time, rinse the Duo filter with running water and clean the coffee maker

Only use drinking water with the Duo filter

Decalcifying

When to decalcify

Minerals found in water can clog the coffee maker or reduce its speed. You will know when such a cleaning is necessary by an obvious slowdown in the brewing time. This extended time indicates that there is a calcium deposit in your coffee maker

Stop n Serve feature

The Stop n Serve feature is for a quick answer to the impatient coffee drinker's answer. You have about 20 seconds between the removal of the carafe and its being reinserted to pour the coffee into the filter. The Stop n Serve device closes off the filter cone so effectively that there is virtually no coffee drip onto the warming plate. Once the carafe is replaced the brewing cycle and the flow of coffee into the carafe are resumed



If coffee does drip onto the warming plate after removal of the carafe it is usually an indication that too much ground coffee is contained in the paper filter. This causes the water that filters into the filter cone to overflow between the paper filter and the sides of the filter cone. The overflow carries coffee grounds that interfere with the stop n serve action of the filter. To avoid this, use brewed coffee to continue to drip the coffee

If this blockage and subsequent dripping occur, replace the glass carafe immediately and allow the full brewing cycle to run its course. Do not remove the filter until the brewing cycle is completed

Preparing "Wake Up coffee (model #625) This feature enables you to enjoy freshly brewed coffee at any pre selected time within a 24 hour period

• First set the digital clock (see Setting the time) • Turn the selector switch (p) to the Prog Setting the extended period of time. Setting the

• This feature enables you to enjoy freshly brewed coffee at any pre selected time within a 24 hour period

• Turn the selector switch (p) to the Prog Setting. The LCD display will flash intermittently. Set the hour and minutes in which you would like the brewing process to commence by pressing the h and m buttons respectively

• Fill the water chamber to the desired number of cups. Place the carafe back on the warming plate

• Place whole beans inside the coffee grinder (B) or ground coffee in the filter (12) and set

- Always unplug the coffee maker before cleaning
- Remove the filter holder and clean the filter holder, the carafe and carafe lid in a solution of hot water and mild liquid soap. These parts can also be placed in the upper level of your dishwasher for safe effective cleaning.
- Never use scouring agents.
- Never immerse the appliance itself in water or any other liquid to clean. Simply wipe off with a soft damp cloth.
- Never use a cloth to clean the inside of the water chamber as this might leave fuzzy deposits in the chamber. Just rinse with cold water periodically.

### Cleaning

- Pour the mixture into the tank and turn the coffee machine in the ground coffee position (without operation of the coffee grinder).
  - Allow about one cup to flow into the scale and then stop.
  - Allow the mixture to sit in the coffee machine to work for about an hour.
  - Switch on the coffee machine again and allow the rest of the quantity to flow out. Rinse the coffee machine thoroughly by operating it two or three times with clean water (full tank).
  - **Caution:** Do not allow the scale removal jacket to fall into children's hands.
- Thanks to the anti-scale action of the filter you will generally only need to decalcify every two to four months depending on the hardness level of your water.
- To decalcify:**
- You can use either a packet of scale remover diluted in two large cups of water or two large cups of colorless vinegar. Scale is removed in the ground coffee position.
  - Before scale removal remove the filter holder (1).
  - Pour the mixture into the tank and turn the coffee machine in the ground coffee position (without operation of the coffee grinder).
  - Allow about one cup to flow into the scale and then stop.
  - Allow the mixture to sit in the coffee machine to work for about an hour.
  - Switch on the coffee machine again and allow the rest of the quantity to flow out. Rinse the coffee machine thoroughly by operating it two or three times with clean water (full tank).
  - **Caution:** Do not allow the scale removal jacket to fall into children's hands.

### Accessories

Coffee Carafe code 629  
 Duo Filter cartridge code 472

**You have followed all these instructions and your machine is still not working**

Call 1 800 526 5377 (US residents only) or visit your nearest authorized Krups service center (see the list in the service booklet).

- You have used too much coffee beans or grounds or the coffee is too finely ground for this drip type coffee machine.
  - The carafe is incorrectly inserted in the coffee machine and has not released the stop mechanism.
  - The filter holder cover is badly positioned. The filter holder is incorrectly inserted in the coffee machine and has not released the stop mechanism.
  - You have used too much coffee beans or grounds or the coffee is too finely ground for this drip type coffee machine.
- Coffee has overflowed from the filter:**
- Main (leakage)
- Your coffee machine is built with a scale removal operation (see Maintenance).
- Check the position of the strength selector. Your coffee machine is built with a scale removal operation (see Maintenance).
- If the time required for the water to flow through the machine is too long or the boiling noise is too loud**
- Check that the filter holder housing (2) is locked.
  - Check that the coffee grinder cover (3) is locked.
  - Check that the machine is set to 'on' and plugged in.
  - Check that the power cord is correctly plugged in.

### If your coffee machine is not working

For the best efficiency of your coffee maker it is strongly recommended after each use to wipe off the coffee grinder (1) to remove the coffee ground strainer (2) to rinse it and wipe it off before putting it back into place (15).

Your KRUPS F615 or F625 is covered by the following warranty:

If within one year from date of purchase this KRUPS product fails to function because of defects in materials or workmanship, KRUPS North America will at its option repair or replace the unit with our charge, provided the owner has a proof of date of purchase.

This warranty will be void if malfunction is caused by damage to the product by accident, misuse, use on the wrong frequency or voltage other than marked on the product, and/or deterioration in the instructions. Abuse including dropping, damage in transit, or use for commercial purposes. This warranty is void if the unit is damaged in any way, or if the unit is used for purposes other than those intended. This warranty does not cover consequential damage or injury to property.

### Limited One Year Warranty

You can purchase KRUPS accessories at your local KRUPS retailer or by calling KRUPS Consumer Service Department at 1-800-537-24 hours a day, 7 days a week (U.S. residents only).



# GUARANTEE OF PERFORMANCE

This fine KRUPS product is manufactured according to a rigid code of quality standards and with minimum care should give years of satisfying service. However should the need arise for repairs or for replacement parts within or after the warranty period please call our CONSUMER SERVICE DEPARTMENT

USA (800) 526 5377

24-hours a day 7 days a week

CANADA (905) 669 0114

Monday Friday 8:00 a.m. - 4:30 p.m.

You will be provided with specific instruction on how to get your product repaired as well as the name and address of your nearest authorized Krups Service Center. The department will also be able to answer any general product questions you may have

Before calling the Consumer Service Department please have the model number of your Krups appliance available. You must have this information before calling our Consumer Service Department so that we may better answer your questions. The model number can be located by looking at the bottom of your appliance

This product is model # F619 or # F625

Any general correspondence can be addressed to

USA

KRUPS North America, Inc  
P.O. Box 3900  
Peoria IL 61612

Canada

KRUPS Service  
20 Caldwell Rd  
Concord Ontario  
L4K 4N8