

This product is affected by the PW recall announced Oct 1998. Please confirm that the product is modified or remediated in accordance with policy.

76173-9993 / 85000

SNAKE BITE™

Age Range: 3-6 Yrs.
 Weight Limit: 65 Lbs.
 Surfaces: Hard, Grass & Carpet
 Speed: 3.5 MPH
 Colors: Red Body
 Intro: 1992
 Suggested Retail: \$159.99 - 179.99
 Warranty: 90 Days Vehicle
 6 Months Battery

TRU Exclusive

Super 6 Volt

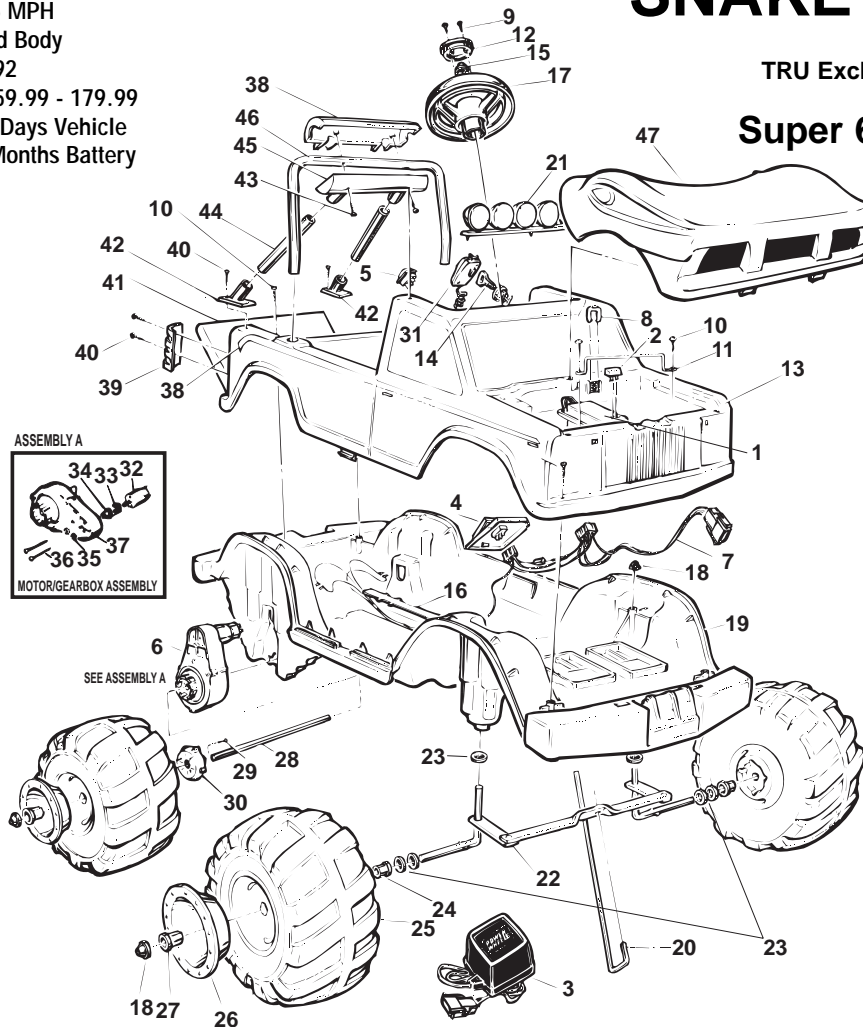

REV 09/12/03

Item No.	Description	Part No.	Qty.	Item No.	Description	Part No.	Qty.	Item No.	Description	Part No.	Qty.
1	** Battery, Type H	00801-0712	1	22	Steering Linkage N/A	78670-4259	1	42	Roll-Bar Bracket Set N/A	80049-0081	1
3	** Charger, Super 6	00801-0974	1	23	7/16" Washer	0801-0196	4	43	#8 x 1-1/2" Screw	0801-0308	2
4	Footboard Assembly	76817-9159	1	24	Round Bushing	74550-2689	2	44	Roll-Bar Support N/A	80049-0076	2
5	** Switch (Fwd.-Rev.)	00801-0885	1	25	Wheel N/A	78471-2469	4	45	Roll-Bar Cover (Lower N/A)	80049-0080	1
6	3 B Motor/Gearbox Assy	74180-9519	2	26	Hubcap N/A	80033-0026	4	46	Roll-Bar N/A	80049-0085	1
7	** <u>Wiring Harness / Ftb Assy N/A</u>	<u>80064-0110</u>	<u>1</u>	27	Hex Bushing	73233-2559	4	47	Hood N/A	76173-2119	1
8	Battery U-Clip N/A	74570-2669	1	28	Rear Axle N/A	80046-0013	1	PARTS NOT SHOWN			
9	#8 x 1" Plascrow N/A	0801-0224	2	29	#10 x 1/2" Phillips Screw	0801-0255	2		Screw For Hood N/A	80006-0033	1
10	#8 x 7/8" Trusshead Screw	0801-0228	6	30	Wheel Driver	73233-2239	2		Twist Lock Clip N/A	78670-0100	1
11	Battery Retainer N/A	76181-4419	1	31	Microphone	74550-9479	1		Literature Bag N/A	80034-0439	1
12	Steering Wheel Cap N/A	80056-0032	1	<u>32</u>	<u>Motor w/Pinion</u>	<u>74580-9539</u>	<u>2</u>		Literature Bag N/A	80034-0439	1
13	Body (Upper) N/A	80005-0247	1	33	D Lock Washer	0801-0329	2		Switch Hole Cover N/A	80001-0092	1
14	Key/Housing Assembly	73233-2439	1	<u>34</u>	<u>Motor Drive Gear</u>	<u>74550-2269</u>	<u>2</u>		Decal Sheet N/A	80017-0206	1
15	Retainer .354 w/Body	0801-0604	1	<u>35</u>	<u>Star Washer N/A</u>	<u>0801-0330</u>	<u>4</u>		Antenna N/A	NLA	
16	Wiring Harness Cove N/A	78471-2459	1	<u>36</u>	<u>Motor Bolts</u>	<u>0801-0269</u>	<u>4</u>				
17	Steering Wheel N/A	80056-0031	1	<u>37</u>	<u>3B Gearbox Only</u>	<u>74550-9279</u>	<u>2</u>				
18	Retainer .437 w/Body	0801-0226	6	38	Roll-Bar Cover (Upper) N/A	80049-0079	1				
19	Body (Lower) N/A	80005-0254	1	39	Taillight N/A	78640-2279	2				
20	Steering Column N/A	78471-4239	1	40	#8 x 1/2" Plascrow	0801-0202	6				
21	Light Rack N/A	80030-0046	1	41	Tailgate N/A	76807-2129	1				



**If the vehicle has red & black connectors, replace the battery (#0801-04314), charger (#0801-0237), harness/footboard assy (#78471-9799), and switches (#76822-9099). (76174) (76173) (pick-ups).

Bold and Underlined parts are to be purchased and installed by Service Centers only. These items may not be sold directly to consumers by Service Centers or Fisher-Price.