

# For 78490-9993 Wranglers produced *after* 3-22-98

Service Bulletin 161

# Revised 78490-9993 Jeep® Wrangler

**Advanced Series  
12-VOLT**

78490-993 Wrangler Phase 2  
(New parts can not retro-fit original style)

- \* Batteries moved from under seat to under hood
- \* New front module
- \* New dash (more leg room)
- \* New windshield / frame assembly
- \* New windshield brackets
- \* New steering column (shorter)
- \* New electrical assembly (footboard, wire harness & shifter)
- \* New battery retainer (no screws necessary)
- \* New seat (lock fastener changed to screw)
- \* New manual
- \* New main decal sheet (dash & front license plate updated)
- \* Screw quantities changed
- \* Motor covers removed / mtgrbox # change as a result
- \* A screw in the shifter handle replaces the H.S. lockout pin.

**Age Range:** 3-7 Yrs.  
**Weight Limit:** 130 Lbs.  
**Surfaces:** Hard, Grass & Hills  
**Speed:** 2.5 / 5.0 MPH Forward  
 2.5 MPH Reverse  
**Colors:** Red Body  
 Black trim  
**Intro:** 3-22-98  
**Suggested Retail:** \$199.99  
**Box Dimensions:** 50.25" x 19.6" x 33.4"  
**In Box Weight:** 68 Lbs.  
**Warranty:** 90 Days Vehicle  
 6 Months Battery  
 Rev. 01/12/04

**This product is affected by the PW recall announced Oct 1998. Please confirm that the product is modified or remediated in accordance with policy.**

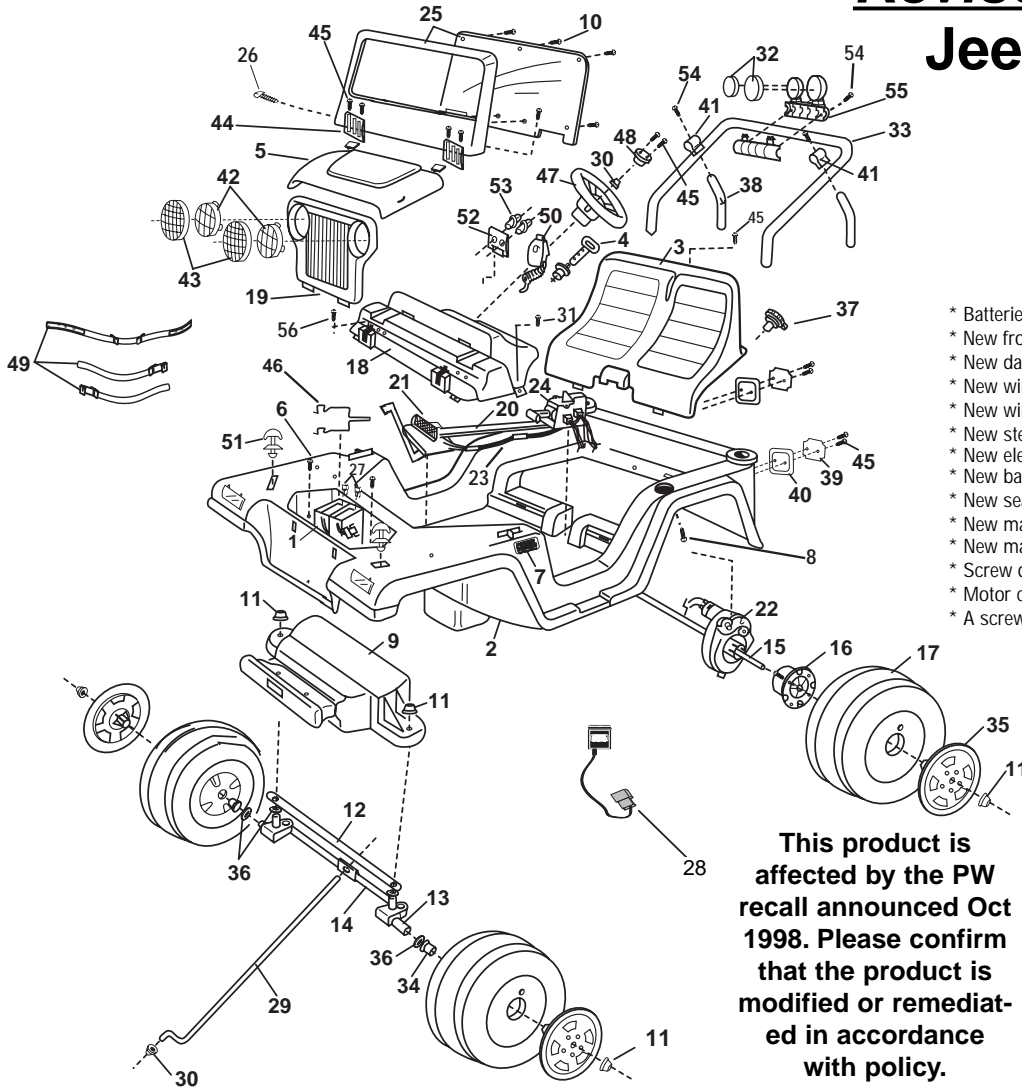

Item No.	Description	Part No.	Qty	Item No.	Description	Part No.	Qty.	Item No.	Description	Part No.	Qty.
1	*Battery	00801-0712	2	25	Windshield Assembly	78490-9769	1	49	Seatbelt Set	74460-5339	1
2	Body N/A	78490-2109	1	26	Frame Screw #10 x 3" N/A	0801-0256	2	50	Mic w/Cord	73233-9479	1
3	Seat	78490-2319	1	27	Thermal Fuse.	0801-0711	1	51	Hood Latch	78480-9559	2
4	Key/Housing Assembly N/A	74550-2439	1	28	*12 Volt Charger	00801-0973	1	52	Knob Bezel	74020-2719	1
5	Hood N/A	74440-2359	1	29	Steering Column	78490-4239	1	53	Dash Knob	74550-2719	2
6	1/4" x 1-1/2" Screw	0801-0578	2	30	.354 Cap Nut (Black)	0801-0604	3	54	#6 x 1-1/2" Screw	0801-0221	4
7	PW Emblem	74460-9069	2	31	#10 x 1/2" Screw N/A	0801-0540	2	55	Light Rack	78457-9349	1
8	1/4"x1-1/2" Roll Bar Scr N/A	0801-0467	2	32	Light Cover	74460-2169	2	56	#10 x 1" Screw (in dash)	0801-0220	2
9	Front Module N/A	78490-2119A	1	33	Sport Bar	74450-9219	1	<b>Parts Not Shown</b>			
10	Screw #8 x 1/2"	0801-0202	7	34	Axle Bushing	74550-2689	2		Decal Main Sheet N/A	78490-0320	1
11	.437 Cap Nut (Black)	0801-0226	6	35	Hubcap	74440-2579	4		*Literature Bag N/A	78490-9029	1
12	Cross Bar	74460-4419	1	36	7/16" Washer	0801-0196	4		*Large Parts Bag #1 N/A	78490-9349	1
13	Front Axle	74440-4509	2	37	Gas Cap	74526-2089	1		Large Parts Bag #2 N/A	78490-9389	1
14	Steering Linkage Assy.	74440-9419A	1	38	Sport Bar Support	78490-2229	2		*Small Parts Bag N/A	78490-9359	1
15	Rear Axle	74440-4519	1	39	Taillight Lens Set	73233-2279	1		<b>Motor W/ Pinion</b>	<b>74440-9579</b>	<b>2</b>
16	Wheel Driver	74460-2249	2	40	Taillight Housing Set	73233-2759	1		<b>#7 Gearbox w/o Motor (Blk)</b>	<b>00968-2802</b>	<b>2</b>
17	Wheel	3800-6799	4	41	Sport Bar Bracket Set	78490-2179	1		*Use & Care Manual	78490-0921	1
18	Dash N/A	78490-268A	1	42	Headlight Lens	74450-2279	2		1/4"x1-1/2" Roll Bar Screws (N/A)	0801-0467	2
19	Grille N/A	74440-2849	1	43	Headlight Lens Guard	74460-2339	2		(order small parts bag)	N/A	
20	Channel Cover N/A	74440-2289	1	44	Windshield Bracket N/A	78490-2779	2		<b>Footswitch</b>	<b>00801-0933</b>	
21	Footboard Assembly	78490-9829	1	45	#8 x 1" Screw N/A	0801-0224	11				
22	**#7 Gearbox w/Motor	00968-2902	2	46	*Battery Retainer	78490-4019	1				
23	<b>*Harness Assembly</b>	<b>78490-9899</b>	<b>1</b>	47	Steering Wheel	74440-2379	1				
24	Shifter Assembly	74310-9239	1	48	Steering Wheel Button	74550-2729	1				

N/A = Not Available

\*\* number w/out motor cover is 78490-9619.

\* See Service Bulletin 161

**Bold and Underlined parts are to be purchased and installed by Service Centers only. These items may not be sold directly to consumers by Service Centers or Fisher-Price.**

