

PHILIPS
NORELCO

SPEED-XL
with Jet Clean System



8160XLCC

*Rechargeable Tripleheader®
Cordless/Cord Razor*

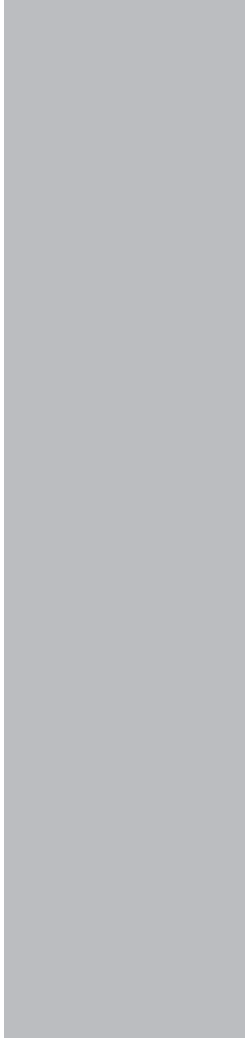

8160XLCC

ENGLISH 4

ESPAÑOL 32

IMPORTANT SAFETY INSTRUCTIONS

When using an electric appliance, basic precautions should always be followed, including the following:

Read all instructions before using this appliance.

DANGER

To reduce the risk of electric shock:

1. Do not reach for a corded razor/Jet Clean System that has fallen into water. Unplug immediately.
2. Use razor only in dry condition. Do not use a razor/Jet Clean System while bathing or in a shower.
3. Do not submerge razor in water.
4. Do not place or store a razor or Jet Clean System where it can fall or be pulled into a tub or sink. Do not place or drop a razor or Jet Clean System into water or other liquid.
5. Always unplug this razor/Jet Clean System from the electrical outlet immediately after use, except when razor is (re)charging.
6. Unplug and remove power supply cord from razor before cleaning.

WARNING

To reduce the risk of burns, fire, electric shock, or injury to persons:

1. Close supervision is necessary when this razor/Jet Clean System is used by, on, or near children or invalids.
2. Use this razor/Jet Clean System for its intended household use as described in this manual. Do not use attachments or a cleaning solution not recommended by Philips Electronics North America Corporation.
3. Never operate this razor/Jet Clean System if it has a damaged cord or charging plug, if it is not working properly, if it has been dropped or damaged, or dropped into water while plugged in. Return the razor/Jet Clean System to the Philips Norelco Service Location for examination and repair.

4. Keep the razor, Jet Clean System, cord and charging plug away from heated surfaces.
5. Never drop or insert any object into any opening.
6. Do not clean, charge or plug in razor/Jet Clean System outdoors or operate where aerosol (spray) products are being used or where oxygen is being administered.
7. Do not use this razor with a damaged or broken comb, as facial injury may occur.
8. Always attach plug to razor/Jet Clean System first, then to outlet. Be certain that plug is inserted firmly into razor/Jet Clean System, up to mark indicated on plug. For Jet Clean System use, always put razor in first, attach cord to Jet Clean System, then plug into outlet. To disconnect, turn razor/Jet Clean System off then remove charging plug from outlet.
9. Never put the razor/Jet Clean System in direct sunlight or store at a temperature above 140°F.
10. Razor can be rinsed under running tap water. Do not charge or operate razor corded until fully dried.
11. Keep the Jet Clean System and cord dry at all times. Do not handle with wet hands. Do not store in a damp environment.
12. To prevent possible damage to the cord, do not wrap cord around the razor or Jet Clean System.

SAVE THESE INSTRUCTIONS

IMPORTANT: The power plug contains a transformer. Do not cut off the power plug to replace it with another plug, as this will cause a hazardous condition.

CAUTION: Keep cleaning solution out of reach of children. Do not take internally. Avoid contact with eyes. In case of eye contact, thoroughly flush with cold water. If irritation persists, get medical attention.



60 - DAY MONEY-BACK GUARANTEE

To enjoy the closest and most comfortable shave from your new Philips Norelco Men's Razor, the razor should be used exclusively for 3 weeks. This allows your hair and skin enough time to adapt to the Philips Norelco Shaving System. If, after that period of time, you are not fully satisfied with your Philips Norelco Men's Razor, send the product back and we'll refund you the full purchase price. **The razor must be shipped prepaid by insured mail, insurance prepaid, and have the sales slip, indicating purchase price and the date of purchase, enclosed.** The razor must be postmarked no later than 60 days after the date of purchase. Philips Norelco reserves the right to verify the purchase price of the razor and limit refunds not to exceed suggested retail price.

Send dated sales slip, your complete name and address as indicated below, and the razor, prepaid to:

Philips Domestic Appliances and Personal Care Company
A Division of Philips Electronics North America Corporation
 450 North Medinah Rd, Dock 16
 Roselle, IL 60172-2329

Please allow 4-6 weeks for delivery of check. (Please Print)

Name _____

Address _____

City _____

State _____ Zip _____

Daytime Telephone No. (____) _____

E-mail Address _____

REASON FOR RETURNING: _____

Table of Contents

Features.....8-11

5 LED Battery Level Indicators12

Before First Use.....13

Charging13-16

Recharging.....16

Quick Charge.....17

Put It To The Test & Shaving Tips17

How To Shave With An
Electric Razor18

Trimming.....19

Cleaning.....19-28

Maintenance.....28

Storage29

Assistance.....30

Accessories.....30

Warranty.....31

Spanish32

Features

Speed-XL Shaving Heads

Razor Head Assembly

Protective Razor Head Cap

Individually Floating Heads

Razor Head Release Button

- Hair Chamber captures shaven hair

Electronic ON/OFF Button

5 LED Charge Indicators

- Indicates the amount of charge remaining in batteries

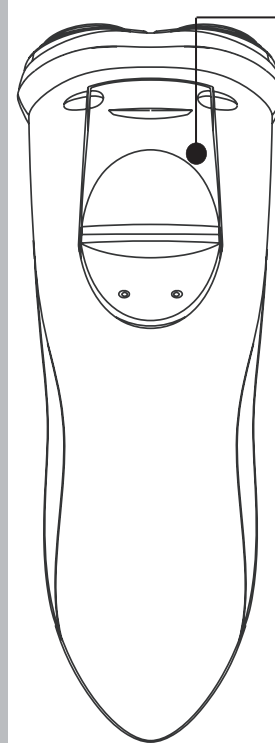
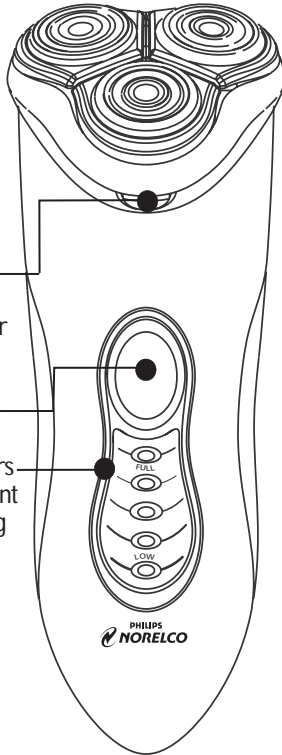

Spring-Release Trimmer

Automatic Worldwide Voltage 100V to 240V AC

Cleaning Brush

Storage/Travel Pouch

Rechargeable - Initial 4 hour full charge for up to 17 days of cordless shave time

1-Hour Quick Charge

Cordless/Cord - To shave with or without a cord

Full 2-Year Warranty

60-Day Money-Back Guarantee

How the Unique  Philips Norelco Lift and Cut® Shaving System Makes Close Comfortable:



Groove channels beard closer to cutting system

Lifter raises hair

Slots to cut long hairs

Holes to cut short hairs even closer

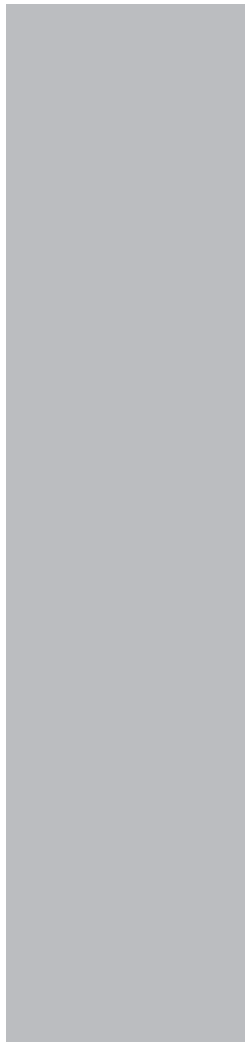

Features

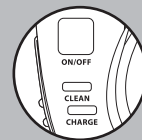
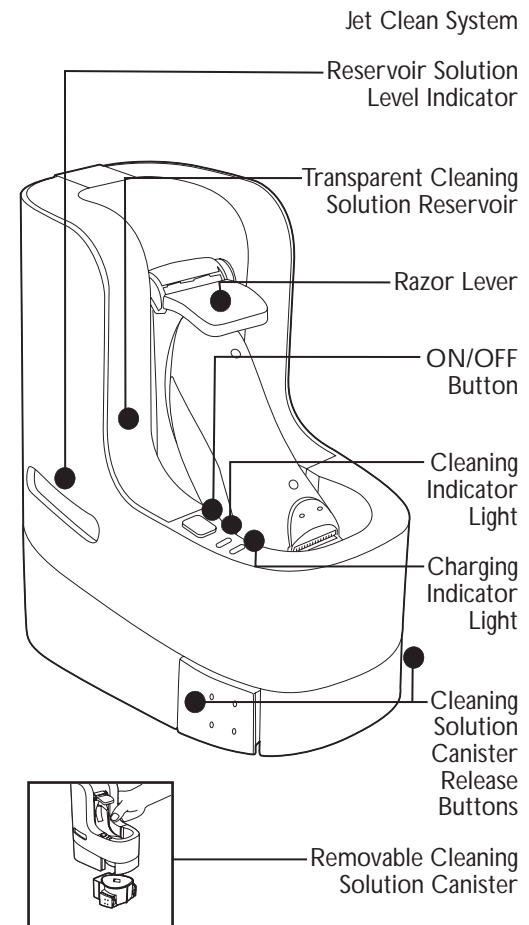

5 LED Battery Level Indicators

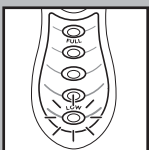

The meter provides the following information:

▶ LED Battery Charge Meter

The Lights on the display indicate approximately how much power is left in the batteries.

▶ Charging Indicator

When you charge razor, the bottom light on the display blinks red. It will then turn green and blink. As charging continues, more and more lights of the display meter will light up green to indicate what level of the batteries have been charged. When the battery contains enough power for one shave, all lights start blinking green sequentially.

▶ Full Charge Indicator

When the batteries have been fully charged, all the lights on the display will light green. A few hours after charging, all lights will go out.

▶ Remaining Battery Capacity

The remaining battery capacity is shown when you unplug the razor or when you switch it on or off.

- When all lights are green, the battery is 100% charged.
- When the bottom light is green, 20% of the battery capacity is left.

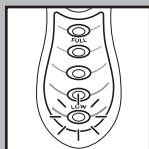

▶ Low Battery Indicator

When the battery is running low, the bottom light on the display lights up red. When you turn the razor OFF, the bottom light will blink a few times.

Before First Use

- ▶ Charge the razor before you start using it (see 'Charging'). Make sure the razor is switched off before you start charging it.

Important

- ▶ Only use the power plug or Jet Clean System provided to charge the razor.
- ▶ The charging plug converts 100 – 240V AC to less than 24V DC.

Charging

- ▶ Battery performance is best if you recharge only when the batteries are (almost) completely empty.
- ▶ Charging or recharging at temperatures below 40°F or higher than 95°F adversely affects lifetime of batteries.
- ▶ Continuously recharging or continuously using as a corded razor will reduce life of batteries.
- ▶ You may also shave using the cord provided. This razor will not recharge while being used corded.
- ▶ Do not charge razor in a pouch.
- ▶ Recharge only when the bottom light on the display lights up red.
- ▶ Do not charge/recharge or use razor corded until fully dried.

Charging Razor with a Cord

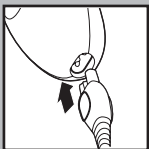

- 1 Connect cord directly to razor and connect the charging plug into any 100V to 240V AC outlet. Use only the charging plug provided.

- ▶ An adaptor plug may be necessary for charging plug usage in some foreign countries. Use an attachment plug adaptor of the proper configuration for the power outlet.

The charging plug will automatically convert to work on 100V to 240V AC systems.

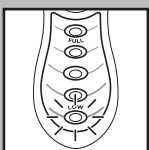

- ▶ As you charge razor, the bottom light on the display blinks red. After a few minutes, it will turn green and blink. As charging continues, more and more lights of the display meter will briefly blink green and light up to indicate what level of the batteries have been charged.

- 2 First time charging and recharging after non-use for 1 month or more requires a full 4 hours. After initial charge, recharging requires 1 hour. A fully charged razor has a cordless shaving time of up to 17 days.

- ▶ When batteries are fully charged, all the 'lights' in the display will light up green. A few hours after charging, all lights go out.

- ▶ Do not leave the razor continuously plugged into outlet as it would reduce the life of the batteries. Remove plug from outlet as soon as razor is fully charged.

Charging Razor with Jet Clean System

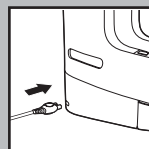

- 1 Connect the small plug to the Jet Clean System. Connect the charging plug into any 100V to 240VAC outlet. Use only the charging plug provided.

The razor holder automatically moves up to the highest position.

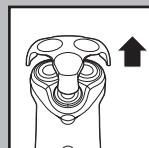

- 2 Remove protective razor head cap from razor.

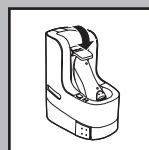

- 3 Place the razor head side down in the razor holder so that the razor head fits into the configuration shown inside the Jet Clean System. Gently press the base of the razor towards the back of the Jet Clean System so that the razor base fits snugly in place. Lock the razor into place by pushing the lever down completely. The lever will not lock down unless the razor has been properly placed in the holder. Do not force lever.

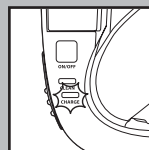

- ▶ The charging light blinks to indicate the razor is being automatically (re)charged and will light up continuously when fully charged.

- 4** First time charging and recharging after non-use for 1 month or more requires a full 4 hours. After initial charge, recharging requires 1 hour. A fully charged razor has a cordless shaving time of up to 17 days.

When batteries are fully charged, the charging light on the Jet Clean System will light up continuously.

- ▶ You may store your razor in the Jet Clean System. Unplug from outlet when charging/cleaning is complete.



- 5** Raise the lever holding the razor to the highest position (1) and carefully remove razor from the Jet Clean System (2).

When razor is removed from the Jet Clean System, the charging light will turn off.

Recharging

- 1** First time charging requires 4 hours. After initial charge, recharging requires 1 hour.

Recharge only when the bottom light on the display lights up red.

- 2** When razor is fully charged, disconnect the charging plug from outlet.

Do not keep razor or Jet Clean System permanently plugged into outlet.

Quick Charge

When batteries are totally depleted, recharging the razor for approximately 3 minutes gives enough energy for a 3-minute cordless shave.

All of the lights on the Charge Meter will blink green sequentially when the battery contains enough energy for a 3-minute cordless shave.

Put It To The Test & Shaving Tips

- ▶ **21 Day Trial and Conversion Process.** It is a fact that your skin and beard need time to adjust to a new shaving system.
- ▶ Use your new razor exclusively for 3 weeks to fully enjoy the closeness of a Philips Norelco shave.
- ▶ At first you may not get as close a shave as you expect, or your face may even become slightly irritated. This is normal since your beard and skin will need time to adjust. Invest 3 weeks and you'll soon experience the full joy of your new razor.
- ▶ **Stick with it!** If you alternate shaving methods during the adjustment period, it may make it more difficult to adapt to the Philips Norelco shaving system.
- ▶ If you are still not convinced after 21 days, Philips Norelco will refund you the full purchase price, guaranteed.

How To Shave With An Electric Razor



- ▶ Use this razor for its intended household use as described in this manual.
- ▶ Shaving with a clean, dry face gives the best results.

1 Turn razor ON by pressing the on/off button once. The blue light ring around the button will light to indicate razor is on. Shave against the direction of beard growth using both straight and circular movements.

▶ When you turn the razor on or off, all lights will light up and then the remaining battery capacity will be shown for a few seconds.

2 Stretch your skin with your free hand so blades can lift and cut whiskers. Gently press razor to skin so the floating heads can follow the contours of your face. DO NOT press too hard. Too much pressure can pinch the skin into the combs.

3 Turn razor OFF by pressing the on/off button once. The blue light ring around the button will go out.

4 Put the protective razor head cap on the razor to protect razor heads.



For optimal shaving results, replace razor heads (model #HQ9) once a year.

Trimming

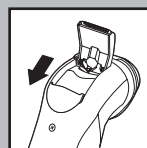

To groom sideburns and moustache:

1 Turn razor ON.

2 Push down spring-release trimmer switch. The trimmer can be activated while the razor is running.



3 Hold trimmer as shown and move in downward strokes with gentle pressure.



4 Close trimmer by pressing trimmer down.

5 Turn razor OFF.

Cleaning

- ▶ Regular cleaning guarantees better shaving results.
- ▶ Always switch Razor OFF, unplug and remove power cord before cleaning.
- ▶ Never clean, remove or replace head assembly while motor is on.
- ▶ Do not apply pressure to combs. Do not touch razor heads with hard objects as this may dent or damage precision-made slotted combs.
- ▶ Do not use razor if combs are damaged or broken. Facial injury may occur.

Preparing Jet Clean System For Use

Important

- ▶ Only use the razor, power plug, Jet Clean System and HQ200 cleaning solution provided to charge or clean razor.
- ▶ Only use a Philips Norelco 'XLCC' model razor with the Jet Clean System.
- ▶ Other Philips Norelco 'X', 'XL' or 'LC' model razors **DO NOT** work with a Jet Clean System.
- ▶ Empty the cleaning solution canister and thoroughly rinse the canister clean with warm water **every 2 weeks**.
- ▶ The Jet Clean System thoroughly cleans but does not disinfect your razor, therefore, do not share razor with others.
- ▶ The charging plug converts 100-240VAC to less than 24V DC.
- ▶ Place the Jet Clean System on a flat, stable surface to avoid any leakage. Be careful not to tip or move the Jet Clean System if it is filled with the cleaning solution.
- ▶ To avoid evaporation, do not expose cleaning solution to direct sunlight.
- ▶ Remove the protective razor head cap from the razor before charging or cleaning the razor in the Jet Clean System.
- ▶ Use this appliance for its intended household use as described in this manual.

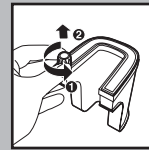
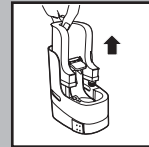

- 1** Place the Jet Clean System on a flat, level surface.
- 2** Lift the transparent cleaning reservoir from the Jet Clean System.
- 3** Turn the reservoir cap counterclockwise (1) and remove from the cleaning reservoir (2).
- 4** Unscrew the lid on the Jet Clean Solution bottle (Model HQ200) provided with the razor. Remove the airtight seal by lifting up the tabs on the seal. Replace lid on the bottle making sure the lid is screwed on securely.
- 5** Open lid and pour the Jet Clean Solution into the transparent cleaning reservoir. The reservoir can be completely filled with one (1) bottle of the Jet Clean Solution (Model HQ200). Discard cleaning solution bottle after contents have been poured into the reservoir.

NOTE: ONLY USE PHILIPS NORELCO JET CLEAN SOLUTION (MODEL HQ200) WITH THE JET CLEAN SYSTEM. ANY OTHER SOLUTION MAY CAUSE DAMAGE TO YOUR RAZOR.

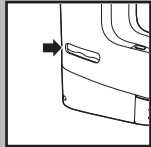

- 6** The amount of cleaning solution in the transparent cleaning reservoir is visible on both sides of the Jet Clean System. When the level gets low, refill with Philips Norelco HQ200 Cleaning Solution.

► The cleaning solution is automatically supplied from the reservoir to the cleaning canister through a special mechanism in the reservoir cap.

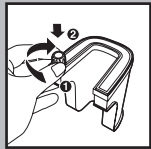

- 7** Replace cap on reservoir (2) and turn clockwise (1) making sure cap is screwed on securely.

► The cleaning solution may foam if the reservoir level is too low. Discard remaining solution, rinse the reservoir with warm water from the tap and refill with new cleaning solution.

► If you clean your razor every day, you should refill the reservoir approximately once a month.



- 8** Carefully lower the cleaning reservoir back into the Jet Clean System making sure the reservoir is properly aligned with the base unit.

Jet Cleaning the Razor

► If the razor does not contain enough power for one (1) shave, the Jet Clean Cleaning System may not work properly. Charge the razor in the Jet Clean System before using it to clean your razor.

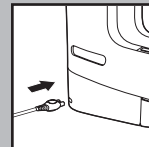

- 1** Connect the small plug to the Jet Clean System. Connect the charging plug into any 100V to 240V AC outlet. Use only the charging plug provided.

The razor holder automatically moves up to the highest position.

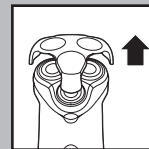

- 2** Place the Jet Clean System on a flat, level surface. Fill the cleaning reservoir with cleaning solution (see 'Preparing Jet Clean System For Use').

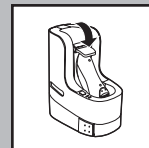

- 3** Remove protective razor head cap from razor.

- 4** Place the razor head side down in the razor holder so that the razor head fits into the configuration shown inside the Jet Clean System. Gently press the base of the razor towards the back of the Jet Clean System so that the razor base fits snugly in place. Lock the razor into place by pushing the lever down completely.

The charging light will blink to indicate the razor automatically begins to charge.



- 5** Press the ON/OFF button to start the cleaning cycle.

The cleaning light on the Jet Clean System starts blinking and the razor is automatically lowered into the cleaning solution. The razor stops charging while it is cleaning.

- ▶ During the first few minutes of the cleaning cycle, the razor will automatically turn on and off several times while the razor holder lowers and raises the razor's position in the cleaning solution, removing all debris.
- ▶ After approximately 5 minutes, the razor holder will be raised slightly and will stay in this position for about 55 minutes. The cleaning light will remain blinking until the entire process is complete.
- ▶ Do not lift the razor lever or press the ON/OFF button while the cleaning cycle is running. If this does occur, the cleaning cycle will stop and the razor holder will automatically move to the highest position. The cleaning cycle can be re-started by pressing the ON/OFF button once.
- ▶ If the power plug is disconnected before the cleaning cycle is complete, the razor holder will remain in its current position. Reconnect the plug into the outlet or Jet Clean System and the razor holder will automatically move to the highest position. The cleaning cycle can be re-started by pressing the ON/OFF button once.

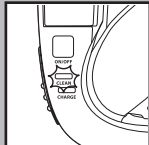

- 6** When the entire cleaning cycle is complete and the razor is hygienically clean, the razor will be raised to the highest position and the cleaning light on the Jet Clean System will light up continuously.
- 7** Raise the lever holding the razor to the highest position (1) and carefully remove the razor from the Jet Clean System (2).

- ▶ You may quickly rinse the razor heads with warm water after using the Jet Clean System to remove any residual cleaning solution.
- ▶ If the razor needs to be recharged, you can simply leave it in the Jet Clean System after cleaning and the razor will automatically recharge. The charging light on the Jet Clean System will blink to indicate the razor is recharging.
- ▶ For optimal razor drying time after cleaning, remove razor from Jet Clean System after the cleaning cycle is complete and allow to air dry.
- ▶ You may store your razor in the Jet Clean System. Unplug from the outlet when charging/cleaning is complete.

Quick Cleaning: Razor Heads

The razor heads may also be quickly cleaned after each use by rinsing with hot water. Water from the tap should be on a hot setting, BUT BE CAREFUL TO TEST WATER FIRST SO AS NOT TO BURN OR SCALD HANDS.

- ▶ Regular cleaning guarantees better shaving results.
- ▶ Do not immerse razor in water.
- ▶ The tap symbol on the back of the razor indicates that the razor can be rinsed under running tap water.
- ▶ While rinsing razor heads, water may drip out of the base of razor. This is a normal occurrence.

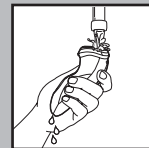
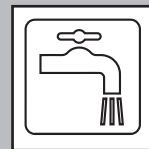



1 Always turn razor OFF, unplug from outlet and remove cord from razor before cleaning.

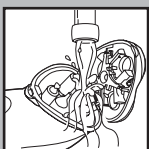

2 Press the Razor Head Release Button, flip open the Razor Head Assembly.

3 Clean inside razor heads and hair chamber by running under hot water.

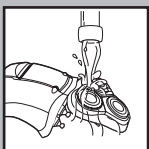

4 Clean outside of Razor Head Assembly by running under hot water.

5 Close the Razor Head Assembly and shake off excess water.

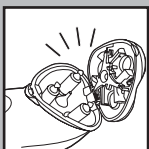

6 Open Razor Head assembly again and leave open to air dry.

NOTE: Do not wipe or dry the shaving heads with a towel or tissue. This could damage the shaving heads.

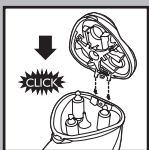

7 If the shaving unit becomes detached from the shaver, you can easily reattach it.

8 You may also clean the hair chamber without water by using the supplied brush.

After Each Use: Trimmer

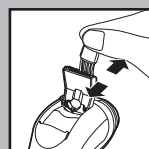

1 Turn razor OFF.

2 Push down spring-release trimmer switch.

3 Clean trimmer with the brush every time you use it.



4 Lubricate the trimmer teeth with Philips Norelco Razor Lubricant (model AL80) or with one drop of mineral oil every 6 months.

5 Close trimmer by pressing trimmer down.

This razor and Jet Clean System have no other user-serviceable parts. Any other service should be performed by the Philips Norelco Service Location.

Cleaning the Jet Clean Canister

For optimal performance of the Jet Clean System, it is recommended that you empty the cleaning solution canister and thoroughly rinse the canister clean every 2 weeks.

1 Place the Jet Clean System on a flat, level surface.

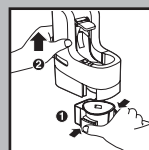

2 Simultaneously press the buttons located on both sides of the Jet Clean System (1) and lift the appliance off the Jet Clean canister (2).

Always remove appliance from canister by lifting straight up. Do not tilt Jet Clean System.



- 3** Discard any remaining cleaning solution in the canister.

The cleaning solution can be safely poured down the sink as there are no harmful ingredients.

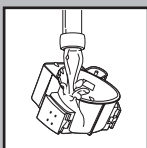

- 4** Simply rinse the canister with warm water. Wipe the canister with a towel or tissue to remove excess water.

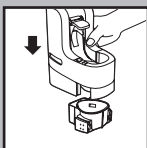

- 5** Carefully lower the Jet Clean System over the canister making sure the release buttons snap back into position.

Maintenance

- ▶ Always remove razor from the Jet Clean System before cleaning appliance.
- ▶ Unplug the Jet Clean System. The Jet Clean System may be wiped clean using a damp cloth.
- ▶ Before refilling transparent cleaning reservoir, discard remaining cleaning solution and rinse the outside and inside of the reservoir completely with warm water from the tap.
- ▶ Water from the tap should be on a warm setting to clean all washable parts.

Note: DO NOT place or clean any parts of the Jet Clean System in a dishwasher.

Storage

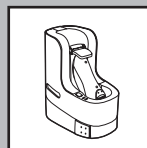

- ▶ The razor can be placed in the Jet Clean System for safe storage. If storing razor in Jet Clean System, remove the plug from outlet as soon as the razor is fully charged or cleaned.
- ▶ If appliance will not be used for an extended period of time, it is recommended that the cleaning solution in both the reservoir and canister be emptied out before storing.
- ▶ Be sure razor is turned off. Remove cord from outlet and razor or Jet Clean System before storing in a safe, dry location where it will not be crushed, banged, or subject to damage.
- ▶ Do not wrap cord around razor or Jet Clean System when storing.
- ▶ Store cord in a safe location where it will not be cut or damaged.
- ▶ Do not keep razor or Jet Clean System permanently plugged into outlet.
- ▶ Do not place or store razor or Jet Clean System where it can fall or be pulled into a tub or sink, water or other liquid while plugged in.
- ▶ If storing razor outside the Jet Clean System, put the Protective Razor Head Cap on razor to protect heads.



Assistance

- ▶ For assistance call toll free:

1-800-243-3050
or visit our website:
www.philips.com/norelco

- ▶ Information is available 24 hours a day, 7 days a week.

Accessories

- ▶ **Replacement Heads**
Model HQ9 - For maximum razor performance, replace your Philips Norelco razor heads once a year or as soon as the replacement head symbol starts blinking.
- ▶ **Razor Lubricant**
AL80 - Philips Norelco Razor Lubricant.
- ▶ **Cleaning Solution**
HQ200 - Philips Norelco Jet Clean Solution, 10 fl. oz. /300 ml.
- ▶ **Car Cord Adaptor Cable**
HQ8010 - Charges razor from a 12V battery in your car, truck, van, boat or camper.
- ▶ **Philips Norelco Razor Accessories may be purchased at a store near you or on our website www.philips.com/norelco**

FULL TWO YEAR WARRANTY

Philips Electronics North America Corporation warrants each new Philips Norelco Product, Model 8160XLCC (except cutters and combs) against defects in materials or workmanship for a period of two years from the date of purchase, and agrees to repair or replace any defective product without charge.

IMPORTANT: This warranty does not cover damage resulting from accident, misuse or abuse, lack of reasonable care, the affixing of any attachment not provided with the product or loss of parts or subjecting the product to any but the specified voltage.* Use of unauthorized replacement parts will void this warranty.

PHILIPS ELECTRONICS NORTH AMERICA CORPORATION WILL NOT PAY FOR WARRANTY SERVICE PERFORMED BY A NON-AUTHORIZED REPAIR SERVICE AND WILL NOT REIMBURSE THE CONSUMER FOR DAMAGE RESULTING FROM WARRANTY SERVICE PERFORMED BY A NON-AUTHORIZED REPAIR SERVICE. NO RESPONSIBILITY IS ASSUMED FOR ANY SPECIAL, INCIDENTAL OR CONSEQUENTIAL DAMAGES.

In order to obtain warranty service, simply ship the product postage prepaid to the Philips Norelco Service Location (information available online at www.philips.com/norelco or at 1-800-243-3050). It is suggested that for your protection you return shipments of product by insured mail, insurance prepaid. Damage occurring during shipment is not covered by this warranty.

NOTE: No other warranty, written or oral, is authorized by Philips Electronics North America Corporation.

This warranty gives you specific legal rights, and you may also have other rights which vary from state to state. Some states do not allow the exclusion or limitation of incidental or consequential damages, so the above exclusion and limitations may not apply to you.

* Read enclosed instructions carefully.

Manufactured for:

Philips Domestic Appliances and Personal Care Company
 A Division of Philips Electronics North America Corporation
 1010 Washington Blvd., Stamford, CT 06912-0015



This symbol on the product's nameplate means it is listed by Underwriters' Laboratories, Inc.

Norelco, Tripleheader, Lift and Cut, and  are Registered Trademarks of Philips Electronics North America Corporation.



is a Trademark of Philips Electronics North America Corporation.

PHILIPS is a Registered Trademark of Koninklijke Philips Electronics N.V.

© 2006 Philips Electronics North America Corporation. All Rights Reserved.