

# BRAUN

WK 210

WK 300

WK 308



# Aqua Express

Type 3217

Type 3219



## Braun Infoline

Deutsch	4, 19, 22
English	5, 19, 22
Français	6, 19, 22
Español	7, 19, 22
Português	8, 19, 22
Italiano	9, 19, 22
Nederlands	10, 20, 22
Dansk	11, 20, 22
Norsk	12, 20, 22
Svenska	13, 20, 22
Suomi	14, 20, 22
Türkçe	15, 20, 22
Polski	16, 20, 22
Русский	17, 21, 22
عربي	18, 21, 22

- (D)** Haben Sie Fragen zu diesem Produkt?  
Rufen Sie an: (in Deutschland und Österreich zum Nulltarif)  
**00 800 27 28 64 63**  
**00 800 BRAUNINFOLINE**
- (CH)** **08 44 - 88 40 10**
- (E)** Servicio al consumidor para España:  
**901-11 61 84**
- (P)** Serviço ao Consumidor para Portugal:  
**808 20 00 33**
- (I)** Servizio consumatori:  
**(02) 6 67 86 23**
- (NL)** Heeft u vragen over dit produkt?  
Bel Braun Consumenten-infolijn:  
**(070) 4 13 16 58**
- (B)** Vous avez des questions sur ce produit ?  
Appelez Braun Belgique  
**(02) 711 92 11**
- (DK)** Har du spørgsmål om produktet? Så ring  
**70 15 00 13**
- (N)** Spørsmål om dette produktet? Ring  
**88 02 55 03**
- (S)** Frågor om apparaten? Ring Kundservice  
**020 - 21 33 21**
- (FIN)** Onko Sinulla kysyttävää tuotteesta? Soita  
**0203 77877**
- (TR)** Türkiye'deki Tüketici Danışma Servisi:  
**0800261 1953**

**Internet:**  
[www.braun.com](http://www.braun.com)

3-219-353/00/XI-01/G2  
D/GB/F/E/P/I/NL/DK/N/S/FIN/TR/PL/RUS/Arab  
Printed in Germany

Kaufdatum  
Date of purchase  
Date d'achat  
Fecha de adquisición  
Data de compra  
Data d'acquisto  
Koopdatum  
Kjøpsdato  
Inköpsdatum  
Дата покупки  
تاريخ الشراء

Kaufdatum  
Date of purchase  
Date d'achat  
Fecha de adquisición  
Data de compra  
Data d'acquisto  
Koopdatum  
Købsdato  
Kjøpsdato  
Inköpsdatum  
Ostopäivä  
Дата покупки  
تاريخ الشراء

Stempel und Unterschrift des Händlers  
Stamp and signature of dealer  
Cachet et signature du commerçant  
Sello y firma del proveedor  
Carimbo e assinatura do revendedor  
Timbro e firma del negozio  
Stempel en handtekening van de handelaar  
Stempel og underskrift av forhandleren  
Återförsäljares stämpel och underskrift  
Штамп магазина и подпись продавца  
امضاء وختم الموزع

Stempel und Unterschrift des Händlers  
Stamp and signature of dealer  
Cachet et signature du commerçant  
Sello y firma del proveedor  
Carimbo e assinatura do revendedor  
Timbro e firma del negozio  
Stempel en handtekening van de handelaar  
Forhandlerens stempel og underskrift  
Stempel og underskrift av forhandleren  
Återförsäljares stämpel och underskrift  
Myyjän leima ja allekirjoitus  
Штамп магазина и подпись продавца  
امضاء وختم الموزع

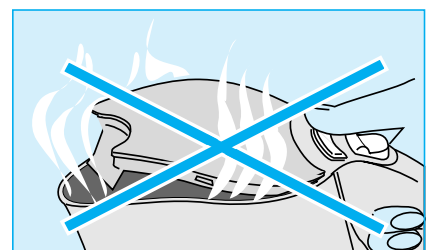
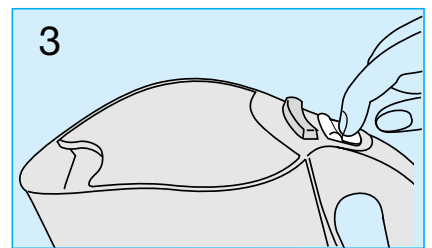
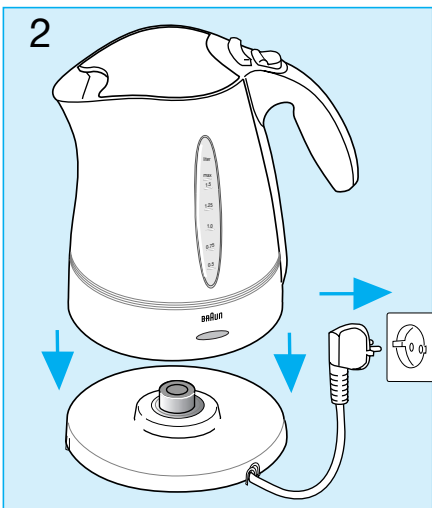
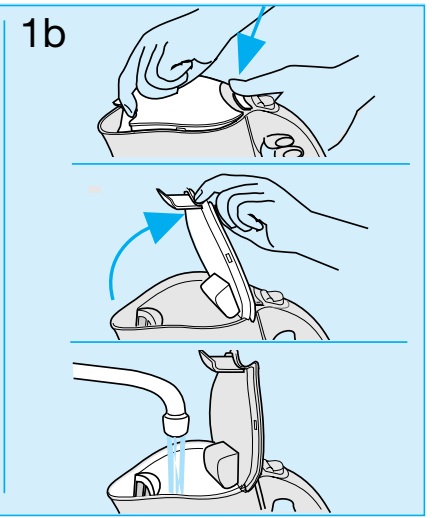
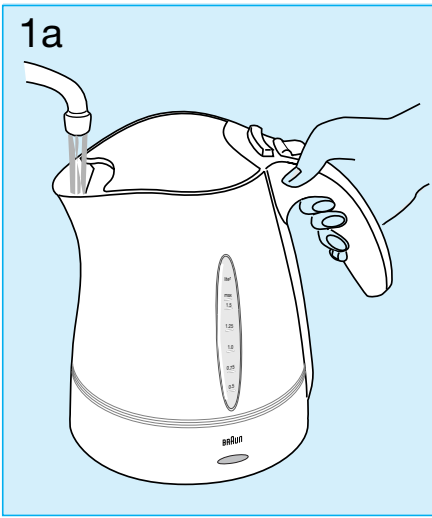
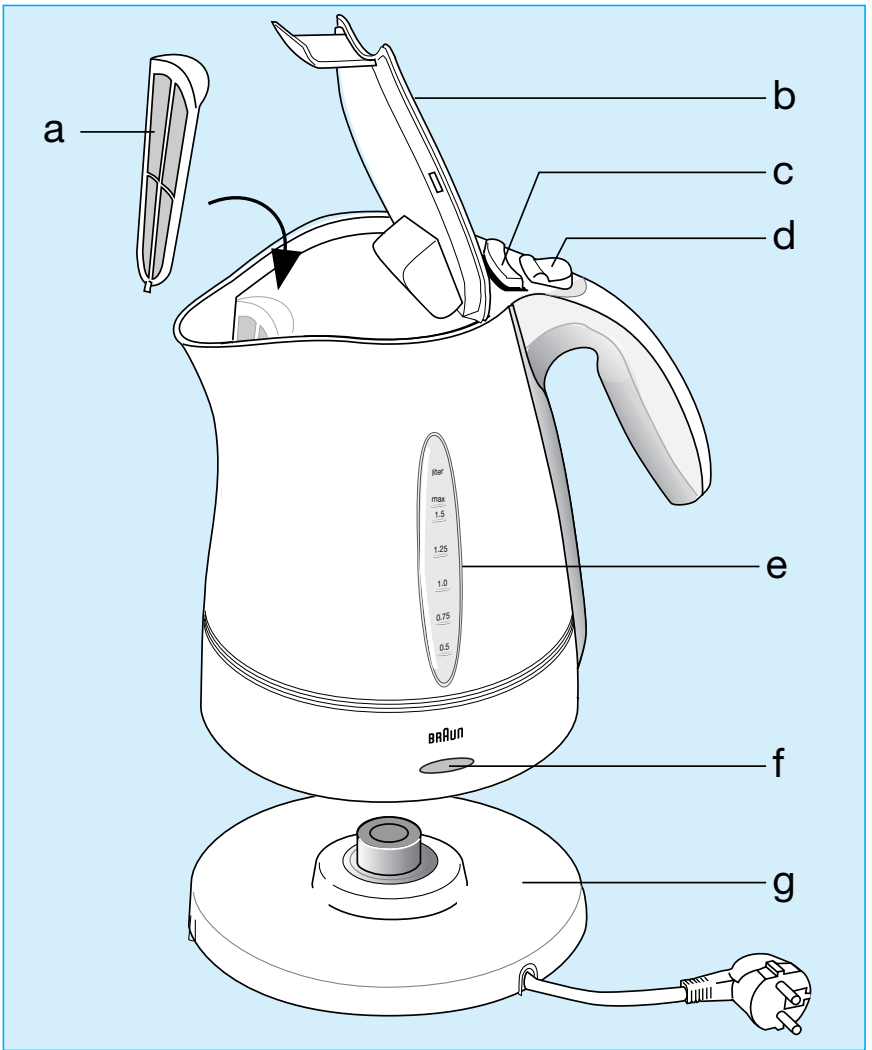

## English

Thank you for purchasing the Braun AquaExpress, we hope that the design and the rapid boil feature give you many years of pleasure.

Before first use, read the use instructions carefully and keep them for future reference.

### Important

- Make sure that your voltage corresponds to the voltage printed on the bottom of the kettle. The kettle may only be operated on the base (g) supplied.  
WK 210 base: Type 3217/S10  
WK 300/308 base: Type 3219/S20
- This appliance is intended for household use only.
- Only use the kettle to heat water.
- Only operate the kettle on a dry, flat and fixed surface.
- Never let the cord hang down from the worktop. The cord length may be reduced by winding it up with the cord storage facility. Keep the appliance out of reach of children.
- The base, the kettle or the cord must never get in contact with hot surfaces (e. g. stove plates).
- In case the empty kettle is switched on accidentally, the overheating protection will cut it off automatically. In this case, allow the kettle 10 minutes to cool down before filling it with water.
- **Caution:** Do not overfill the kettle! Water could boil over and cause scalding.
- Do not open the lid while water is boiling.
- During operation, the kettle will get hot. Therefore only use the handle to carry it. Hold the kettle horizontally, not at a slanted position, otherwise water can come out.
- Check the cord regularly for possible damage.
- If the appliance shows any defect, stop using it and take it to a Braun Service Centre for repair. Faulty or unqualified repair work may cause accidents or injury to the user.
- Braun electric appliances meet applicable safety standards.  
Model WK 300/308 only:
- Make sure not to operate too many other electric appliances when using the kettle.
- Socket fuse at least: 16 A

### Description

- a Scale filter (removable)
- b Lid
- c Lid release button
- d On/off switch
- e Water level indicator
- f Pilot light
- g Base with cord storage

- Max. capacity: 1.6 l water

### Before first use

Before using the kettle for the first time, fill it up twice with water to the maximum level and bring it to boil. Empty the kettle after boiling each time.

### Setting into operation

- 1a Fill the kettle through the spout with the lid closed,  
or:  
1b Press the lid release button (c), open the lid, fill with water and close the lid again (the kettle will not work with the lid open).
- 2 Place the kettle on the dry base and plug in the base.
- 3 Press the on/off switch (d), the pilot light will come on (do not open the lid when the kettle is switched on).
- 4 When the water has boiled, the kettle automatically switches off.  
You may also stop the heating procedure at any time by pressing the on/off switch (d).

### Automatic cut-off feature

The kettle switches off when...

- the water has boiled,
- it contains no water (in case of accidental switching on),
- the lid is opened,
- it is taken off the base.

If the scale filter is not installed, the automatic cut-off will be delayed.

### Cleaning

Before cleaning, unplug the base. Kettle or base must never be immersed in water. Clean the outside of the kettle with a damp cloth, the inner part can be cleaned by means of a brush. The removable scale filter is dishwasher-proof.

### Descaling

- In order to extend the lifetime of the kettle, it should be descaled regularly.
- Boil 0.8 l water in the kettle.
- Important: Switch off the kettle and add 0.4 l household vinegar (4% acid). Do not boil the contents as it may cause spilling being a danger of scalding.
- Let the mix of water and vinegar sit in the kettle overnight.
- Empty the kettle and rinse the inside thoroughly with fresh water. Fill the kettle with fresh water and boil it.
- Empty the kettle and rinse it again with fresh water.
- If the kettle still contains scale, repeat this procedure.
- To remove any scale from the scale filter, you may soak it in diluted vinegar.

Subject to change without notice.

This product conforms to the EMC-Requirements as laid down by the Council Directive 89/336/EEC and to the Low Voltage Regulation (73/23 EEC).

