

# BRAUN

## Braun Flex Integral 5550 universal

Type 5504

[English](#)  
Use Instructions  
Guarantee  
Service Centers

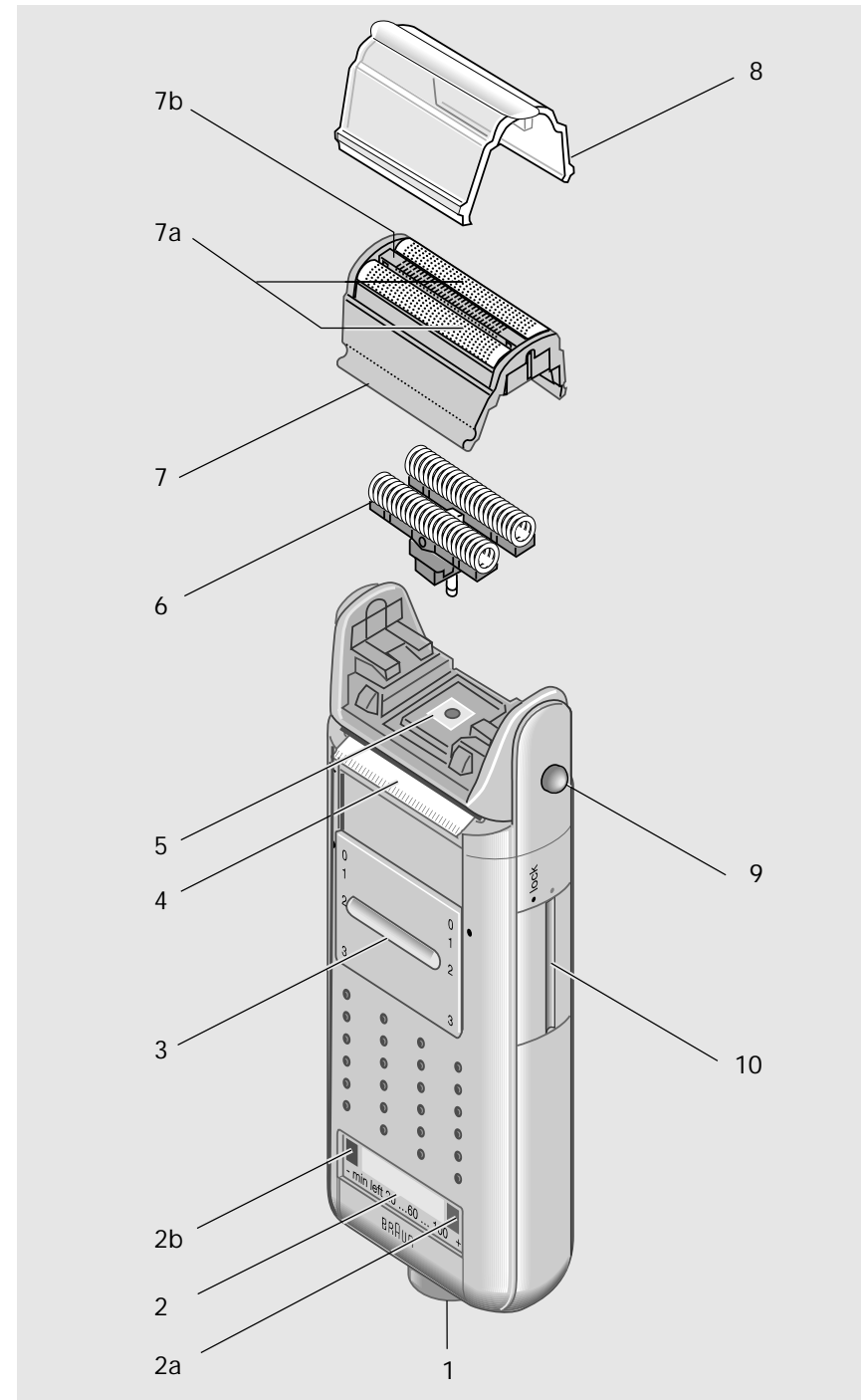

## English

Our products are engineered to meet the highest standards of quality, functionality and design. We hope you thoroughly enjoy your new Braun appliance.

### Caution

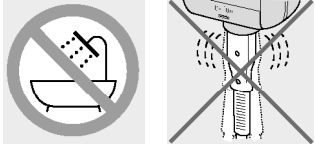

- Do not use the shaver near or over basins filled with water (e. g. bath tubs, showers etc.).
- Periodically check the cord for damages particularly at each end where the cord enters the plug.
- Replace the cord for safety reasons, if it is loose in the shaver socket ①.
- Do not wind the cord around the shaver.

### Braun Flex Integral 5550 universal

#### Pivoting head and triple shaving system

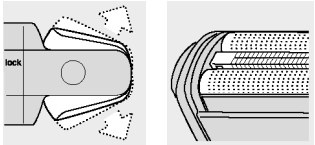

This shaver is equipped with a pivoting head which has a triple shaving system with an integrated longhair cutter. The pivoting head swings to both sides and thus automatically adjusts itself to the contours of your face within its swinging angle. The triple shaving frame ⑦ with its twin foil ②a and the integrated longhair cutter ②b provide a permanent combination shave. This means that the integrated longhair cutter cuts the longer hairs, while the twin foil ②a together with the cutterblock ⑧ under the foil, provide a close shave – all in one stroke.

### Specifications

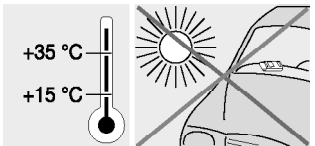

- Wattage: 6 W.
- Voltage range «mains operation»: 100 - 240 V  $\approx$  50 / 60 Hz (automatic adaption of voltage and frequency).
- Voltage range charging (for cordless operation): 12 - 240 V  $\approx$  50 / 60 Hz (automatic adaption of voltage and frequency).
- Lowest charging voltage: 12 V (-) d. c.
- Best environmental temperature range: + 15 °C to + 35 °C. Never expose the shaver to temperatures of less than 0 °C or more than + 40 °C for longer than a few hours.
- This product conforms to the EMC-Requirements as laid down by the Council Directive 89/336/EEC.

### Environmentally friendly cell unit



For environmental reasons, this appliance is provided with a nickel-hydrid cell unit. This cell unit does not contain any poisonous heavy metals. Nevertheless, in the interest of recycling raw materials please do not dispose of this appliance in the household waste at the end of its useful life. Disposal can take place at a Braun Service Centre or at appropriate collection sites.

For easy recycling this shaver is equipped with a screw mechanism in the shaver socket ①. Puncturing the seal of this mechanism and subsequently turning it, must only be done at the end of the useful life of the shaver. We recommend to have this done by a Braun Service Centre.

### Cell removal

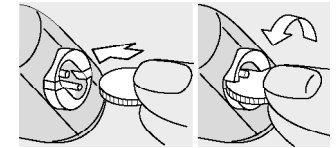

- ① Shaver socket
- ② Function display (LCD)
- ②a Charging light (green)
- ②b Low-charge light (red)
- ③ Switch
- ④ Longhair trimmer
- ⑤ Cutterblock base
- ⑥ Duo cutterblock
- ⑦ Triple shaving frame
- ②a Twin foil
- ②b Integrated longhair cutter
- ⑧ Foil protection cap
- ⑨ Button for releasing the triple shaving frame ⑦
- ⑩ Switch lock

#### Switch positions:

- 0 = Off (when not in use and always when charging)
- 1 = Shaving with the twin foil ②a and the integrated longhair cutter ②b
- 2 = Shaving with the pivoting head locked at an angle to permit shaving under the nose or at the hairline
- 3 = The longhair trimmer ④ is activated

The shaver was delivered with the switch lock activated (position «● lock»). Push the switch lock ⑩ to position «●» before you shave for the first time. To avoid accidentally switching on the shaver, push the switch lock to position «● lock».

### Description

#### Switch ③

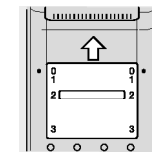

#### Switch lock

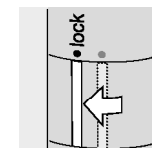

## Cordless shaving/charging

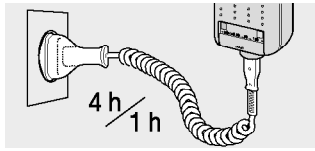

When charging the shaver for the first time, connect it to the mains (100 - 240 V) and charge it for 4 hours to full capacity. Then discharge the shaver through normal shaving until the low-charge light ⑭ lights up.

Recharge the shaver for 1 hour. This charging method preserves the maximum capacity of the cell unit. All subsequent charges will also take only 1 hour (quick charging). The shaver automatically adapts to all direct and alternating current voltages (12 - 240 V) and to frequencies of 50 or 60 Hz. Recharging on 12 V (-) in cars or boats, takes approximately 20 hours. The surrounding temperature should not exceed + 25 °C.

A full charge will give up to about 70 minutes of cordless shaving (approximately 20 days based on 3.5 minutes per shave), depending on the thickness of your beard.

## State of the shaver and cell unit

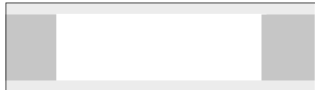

## Preserving the cell unit

The LCD function display ② and the lights ⑭, ⑮ show the state of the shaver and the rechargeable cell unit, also taking into account the normal self-discharge.

The cell unit is discharged; nothing is shown on the display. The shaver does not work.

The cell unit is discharged, but the shaver is connected to the mains. The green charging light ⑮ is on.

After 60 minutes of charging all segments are on the LCD display ②. The green charging light ⑮ goes off. The cell unit is charged to full capacity.

The cell capacity is shown in 20 % steps, e. g. charged up to 40 % capacity: the segments 20 % and 40 % are shown.

Less than 20 % capacity: half of the 20 % segment and the figure «9» (showing the remaining minutes) are on the display. When the shaver is switched on, the low-charge light ⑭ flashes too.

The figure «0» is on the LCD display, and the motor stops. Recharge the shaver at this point at the latest.

The shaver preserves the cell unit automatically. About once a year the shaver discharges and recharges the cell unit automatically, if connected to the mains. This procedure takes approximately 7 hours.

Connect the shaver to the mains and turn the shaver on (see switch ③). If the shaver should not run immediately – because of the discharged cell unit – leave it plugged in with the switch ③ set to «0», for approximately 1 minute. Thereafter, you can shave with cord plugged into the outlet.

**Notice:** Shaving directly via the cord on voltages below 100 V (in cars, boats etc.) is not possible.

- Take off the foil protection cap ⑧.
- For shaving, push the switch ③ to setting «1».
- Hold the shaver at right angles (90°) to the skin.
- Stretch the skin with your free hand.
- Guide the shaver smoothly against the direction of beard growth, applying only gentle pressure.

The pivoting cutting system (twin foil ⑩ and integrated longhair cutter ⑦) follows the contours of your face automatically.

While shaving difficult parts of your face (e. g. under the nose or at the hairline), push switch ③ to setting «2», to lock the pivoting head at an angle.

To activate the longhair trimmer, move the switch ③ to setting «3». The longhair trimmer moves upwards and allows easy and exact trimming of the side burns.

Move the switch ③ back to setting «0».

**Important:** After every shave, put the foil protection cap ⑧ on the pivoting head.

## Shaving with the cord

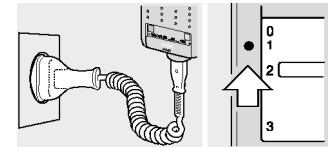

## Shaving

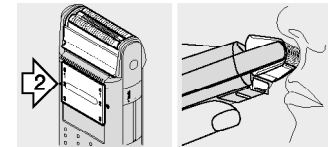
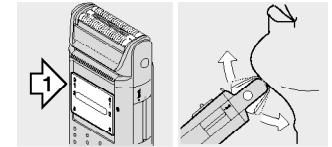
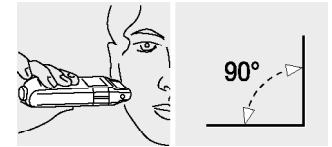

## Longhair trimmer ④

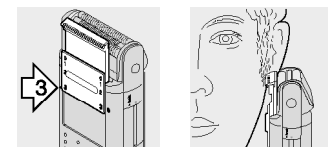

## Switching the shaver off

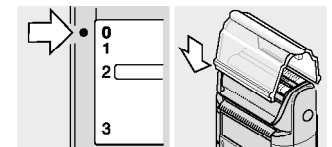

## Cleaning and maintenance

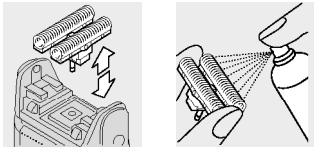
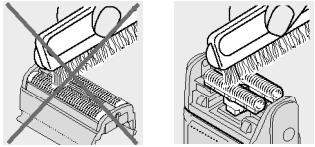
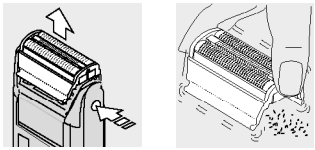

## Purchasing spare parts

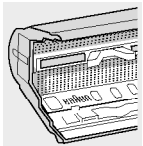

## Parts for an automobile or boat



Switch the shaver off.

After each shave take off the triple shaving frame ⑦. Press the button ⑨ to release the triple shaving frame and pull it off.

Tap out slightly the triple shaving frame. Do not clean the twin foil ⑫ with the brush.

Clean the duo cutterblock ⑥ thoroughly with the brush. Move the duo cutterblock crosswise and take it off. Brush out the entire pivoting head area, including the cutterblock base ⑤. After cleaning place the duo cutterblock back into the cutterblock base ⑤ and replace the triple shaving frame ⑦ until it clicks into place.

Approximately every four weeks clean the duo cutterblock ⑥ with Braun cleaning agents.

After every cleaning replace the foil protection cap ⑧.

The triple shaving frame and duo cutterblock are precision parts that will wear out over time. To maintain optimal shaving performance you should replace these parts when worn. This will ensure that you continue to get the close, comfortable shave you expect from your Braun shaver.

**Important:** Buy only original Braun spare parts, especially when replacing the cord or the triple shaving frame ⑦. When replacing the triple shaving frame look for the **BRAUN** brand. Only this way you will obtain a perfect shave.

Triple shaving frame ⑦: Remove as described under «Cleaning and maintenance». Set the new triple shaving frame on the pivoting head until it clicks into place. Handle with care.

Duo cutterblock ⑥: Take as described under «Cleaning and maintenance». Place the new duo cutterblock into the cutterblock base ⑤ until it clicks into place.

For safety reasons use only the Braun charging cord No. 5-001-687 (stated on the packaging). It is available from your dealer or from a Braun Service Centre.

## Mounting on brick, wooden wall or tiles:

Fix the wall holder with the sticker foil and a screw and wall plug (e. g. plastic filler) if necessary.

- Remove grease from tiles first (e. g. with alcohol).
- Remove protective strip from the wall holder.
- Press wall holder firmly to the wall.
- Connect the cord of the shaver to the wall holder from underneath and plug the cord into an electrical outlet (A).
- Put the shaver into the wall holder. At this stage the shaver is not connected to the cord (B).
- Press one of the bars on the wall holder for charging only (C). This lowers the shaver, connecting in to the charging plug. The green charging light on the shaver shows that it is being charged.
- Do not charge continuously for several weeks.

Subject to change without notice.

## Wall holder for controlled charging

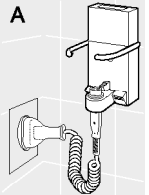
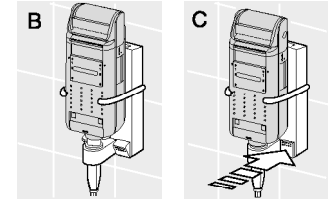
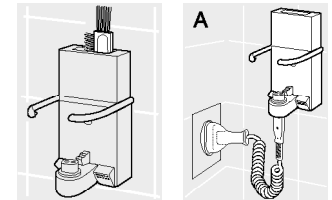

## Tips for the perfect shave

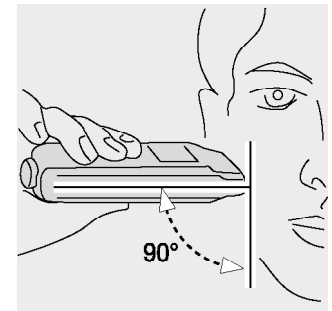

- It is recommended to shave before washing your face; your skin is slightly swollen after washing.
- Hold the shaver at right angles (90°) to the skin.
- Stretch your skin and shave against the direction of beard growth.
- Clean the shaver after every shave (see «Cleaning and maintenance»). A poorly cleaned shaver has a reduced shaving performance.
- Use only properly functioning shaving parts.

## Guarantee

We grant a 1 year guarantee on the product commencing of the date of purchase.

Within the guarantee period we will eliminate, free of charge, any defects in the appliance resulting from faults in material or workmanship either by repairing, or exchanging parts or exchanging the whole appliance as we may choose.

Not covered by this guarantee: damage arising from improper use (operation with incorrect current/voltage, plugging it into an unsuitable power point, kinks in the shaving foil, breakage), normal wear on the shaving foil and defects which have a negligible effect on the value or operation of the appliance.

The guarantee becomes void if repairs are undertaken by unauthorized persons and if original Braun parts are not used.

The guarantee only comes into force if the date of purchase is confirmed by the dealer's stamp and signature on the guarantee card and registration card, and if the registration card is sent to the Braun guarantee office within 4 weeks of purchase.

This guarantee extends to every country where this appliance is supplied by Braun or its appointed distributor and where no import restrictions or other legal regulations hinder or prevent service being given under guarantee.

Service under the guarantee does not affect the expiry date of the guarantee. The guarantee on parts or entire appliances which are exchanged ends when the guarantee on this appliance expires.

In the event of a claim under this guarantee, hand in the complete appliance with the valid guarantee card to your dealer, or send both to the nearest Braun Customer Service Centre.

All other claims including for damages resulting from this guarantee are excluded unless our liability is legally mandatory.

Those claims arising out of the sales contract with the vendor are not affected by this guarantee.

**For UK only:**

This guarantee in no way affects your rights under statutory law.