

# BRAUN

2540  
2560



# Braun 2000

Type 5596



## Braun Infoline

Deutsch	4, 41, 51
English	6, 41, 51
Français	8, 41, 51
Español	10, 42, 51
Português	12, 43, 51
Italiano	14, 44, 51
Nederlands	16, 44, 51
Dansk	18, 45, 51
Norsk	20, 45, 51
Svenska	22, 45, 51
Suomi	24, 46, 51
Türkçe	26, 51
Polski	28, 46, 51
Ελληνικά	31, 47, 51
Русский	34, 48, 51
عربي	40, 50, 51

### Internet:

[www.braun.com](http://www.braun.com)

5-596-278/00/XI-01/G2  
D/GB/F/E/P/I/NL/DK/N/S/FIN/  
TR/PL/GR/RUS/Arab

- D** Haben Sie Fragen zu diesem Produkt?  
Rufen Sie an: (in Deutschland und  
Österreich zum Nulltarif)  
**00 800 27 28 64 63**  
**00 800 BRAUNINFOLINE**
- CH** **08 44 - 88 40 10**
- E** Servicio al consumidor para España:  
**901-11 61 84**
- P** Serviço ao Consumidor para Portugal:  
**808 20 00 33**
- I** Servizio consumatori:  
**(02) 6 67 86 23**
- NL** Heeft u vragen over dit produkt?  
Bel Braun Consumenten-infolijn:  
**(070) 4 13 16 58**
- B** Vous avez des questions sur ce  
produit ?  
Appelez Braun Belgique  
**(02) 711 92 11**
- DK** Har du spørgsmål om produktet? Så ring  
**70 15 00 13**
- N** Spørsmål om dette produktet? Ring  
**88 02 55 03**
- S** Frågor om apparaten? Ring Kundservice  
**020 - 21 33 21**
- FIN** Onko Sinulla kysyttävää tuotteesta?  
Soita  
**0203 77877**
- TR** Türkiye'deki Tüketici Danışma Servisi:  
**0 800 261 19 53**

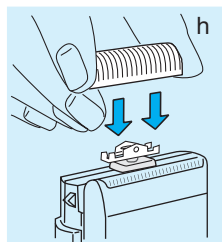
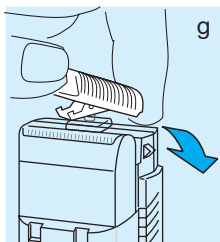
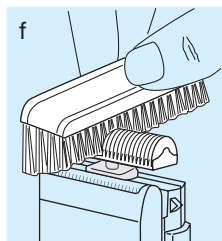
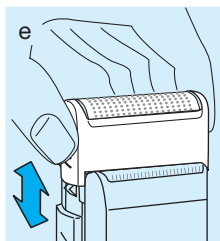
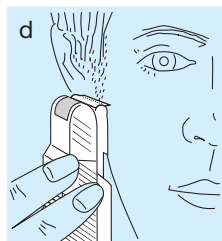
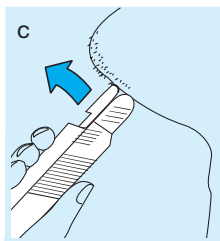
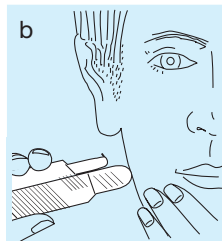
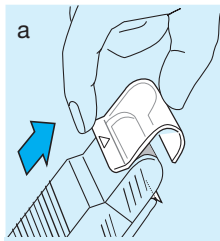
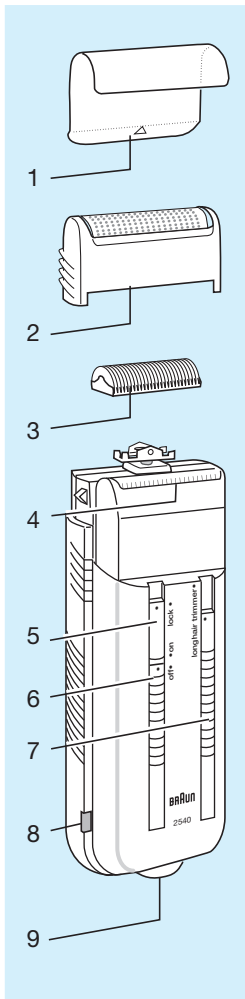

# English

Our products are designed to meet the highest standards of quality, functionality and design. We hope you entirely enjoy your new Braun shaver.

## Caution

- Do not use the shaver near, or over, basins filled with water (e.g. bath tubs, showers etc.).
- For safety reasons, periodically check the cord for damage and replace it, if it is loose in the shaver socket.

## 1 Description

- |                       |                           |
|-----------------------|---------------------------|
| ① Foil protection cap | ⑥ On/off Switch           |
| ② Foil frame          | ⑦ Longhair trimmer switch |
| ③ Cutter block        | ⑧ Charging light          |
| ④ Longhair trimmer    | ⑨ Shaver socket           |
| ⑤ Switch lock         |                           |

## 2 Charging the shaver

- For the 3 first chargings: Connect the shaver to the mains and charge it for at least 4 hours (switch position «off»). After the cell unit is fully charged, the green charging light goes off. If later on, the charging light comes on again, this indicates that the shaver is being recharged to maintain its full capacity. Then shave without the cord until the shaver runs distinctly slower. The full capacity is reached after several charge/discharge cycles.
- Wattage: 5 Watts  
Voltage range during charging: 12 – 240 V  $\simeq$  / 50 or 60 Hz (automatic adaption)  
Best environmental temperature range for charging: 15 °C to 35 °C
- Charging cord as of 12 V (for boat or car, available from your dealer or at Braun Service Centres, No. 5-001-687). Recharging with this cord takes about 20 hours.

## 3 Shaving

### 3.1 Switch lock

The shaver is delivered with the switch lock activated (position «lock»). Push the switch lock up before you shave for the first time. To avoid accidentally switching the shaver on, e. g. when travelling, push the switch lock to position «lock».

### 3.2 Switch positions

off

on = Normal shave

longhair trimmer = The longhair trimmer is activated

- for exact trimming of sideburns, moustache and beard (d),
- combination shave (simultaneous use of longhair trimmer and shaving foil) (c).  
First, the longhair trimmer cuts off the longer «problem hairs», then the foil follows to give a close, smooth shave.

### 3.3 Shaving with the cord

If the cell unit is discharged, you may also shave with the shaver connected to the mains (100 – 240 V  $\simeq$ ). (If the shaver should not run immediately, charge it with the switch on position «off» for approx. 1 minute.)

### Tips for the perfect shave

- We recommend to shave before washing, as the skin tends to be slightly swollen after washing.
- Hold the shaver at right angles (90°) to the skin.
- Stretch your skin and shave against the direction of beard growth.

## 4 Keeping your shaver in top shape

### 4.1 Cleaning

- After shaving, switch the shaver off. Remove the foil frame ② (e) and gently tap it out on a flat surface.
- Then thoroughly clean the cutter block ③ with the brush (f). About every four weeks, clean the cutter block with Braun cleaning agents.
- Do not clean the shaving foil with the brush.
- If you have a very dry skin and you notice a reduced operation time of the shaver, you should put a drop of sewing machine oil onto the shaving frame.

### 4.2 Changing the shaving parts

- To maintain optimum shaving performance, we recommend to replace the shaving frame and the cutter block every 1 ½ year or when these parts are worn.
- Pull off the foil frame (e). Replace the new foil frame in the right direction until it locks in place.
- To remove the cutter block, set it in crosswise position and lift it off (g). To replace the cutter block, snap onto the holding studs (h).

### 4.3 Preserving the cell unit

- In order to maintain the capacity of the cell unit, the shaver has to be discharged by shaving every 6 months approximately. Then recharge the shaver to full capacity again.
- Do not expose the shaver to temperatures of more than 50 °C for longer periods of time.

## 5 Environmental notice

This appliance is provided with a nickel-hydride cell unit.

This cell does not contain any harmful heavy metals. Nevertheless, please do not dispose of this appliance in the household waste at the end of its useful life. Disposal can take place at a Braun Service Centre or appropriate collection sites. However, if you prefer to dispose of the cell unit yourself, remove the cell unit as shown on page 54.



Subject to change without notice.

This product conforms to the EMC-Requirements as laid down by the Council Directive 89/336/EEC and to the Low Voltage Regulation (73/23 EEC).



# Deutsch

## Garantie

Als Hersteller übernehmen wir für dieses Gerät – **nach Wahl des Käufers zusätzlich zu den gesetzlichen Gewährleistungsansprüchen gegen den Verkäufer** – eine Garantie von 2 Jahren ab Kaufdatum. Innerhalb dieser Garantiezeit beseitigen wir nach unserer Wahl durch Reparatur oder Austausch des Gerätes unentgeltlich alle Mängel, die auf Material- oder Herstellungsfehlern beruhen. Die Garantie kann in allen Ländern in Anspruch genommen werden, in denen dieses Braun Gerät von uns autorisiert verkauft wird.

Von der Garantie sind ausgenommen: Schäden durch unsachgemäßen Gebrauch, normaler Verschleiß und Verbrauch sowie Mängel, die den Wert oder die Gebrauchstauglichkeit des Gerätes nur unerheblich beeinflussen. Bei Eingriffen durch nicht von uns autorisierte Braun Kundendienstpartner sowie bei Verwendung anderer als Original Braun Ersatzteile erlischt die Garantie.

Im Garantiefall senden Sie das Gerät mit Kaufbeleg bitte an einen autorisierten Braun Kundendienstpartner. Die Anschrift für Deutschland können Sie kostenlos unter 00 800/27 28 64 63 erfragen.

# English

## Guarantee

We grant 2 years guarantee on the product commencing on the date of purchase. Within the guarantee period we will eliminate, free of charge, any defects in the appliance resulting from faults in materials or workmanship, either by repairing or replacing the complete appliance as we may choose.

This guarantee extends to every country where this appliance is supplied by Braun or its appointed distributor.

This guarantee does not cover: damage due to improper use, normal wear or use as well as defects that have a negligible effect on the value or operation of the appliance.

The guarantee becomes void if repairs are undertaken by unauthorised persons and if original Braun parts are not used.

To obtain service within the guarantee period, hand in or send the complete appliance with your sales receipt to an authorised Braun Customer Service Centre.

### For UK only:

This guarantee in no way affects your rights under statutory law.

# Français

## Garantie

Nous accordons une garantie de deux ans sur ce produit, à partir de la date d'achat. Pendant la durée de la garantie, Braun prendra gratuitement à sa charge la réparation des vices de fabrication ou de matières, en se réservant le droit de décider si certaines pièces doivent être réparées ou échangées, ou encore si l'appareil lui-même doit être échangé.

Les dommages occasionnés par une utilisation inadéquate ou rangement (branche-