

Braun 1508 universal

Type 5597

- English
4 Use instructions
7 Guarantee
35 Service Centers

- Русский
8 Инструкция по эксплуатации
10 Гарантия
35 Сервисные центры

- Українська
13 Інструкція з експлуатації
15 Гарантія
35 Сервісні центри

- Latviešu
16 Lietošanas instrukcijas
18 Garantija

- Eesti
19 Kasutusjuhend
21 Garantii

- Lietuvių
22 Naudojimo instrukcija
24 Garantija

- 中文
25 使用說明
29 保證書

- عربي
34 طرق الاستعمال
30 ضمان
35 مراكز الكفالات والصيانة

BRAUN

5-597-187/00/VIII-01
GB/RUS/UA/LV/EST/LT/PRC/Arab

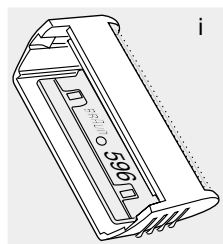
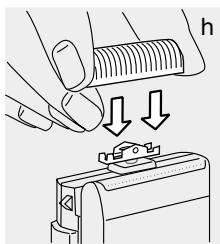
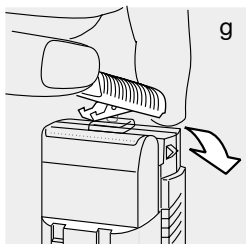
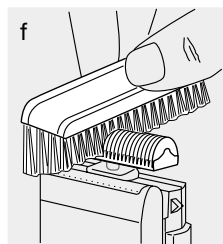
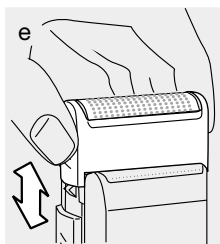
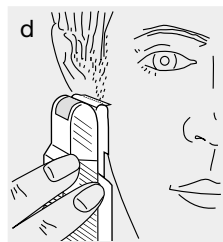
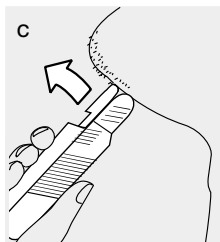
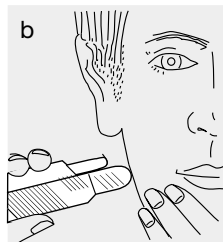
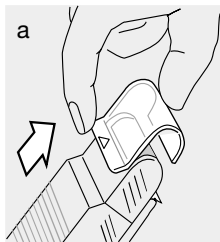
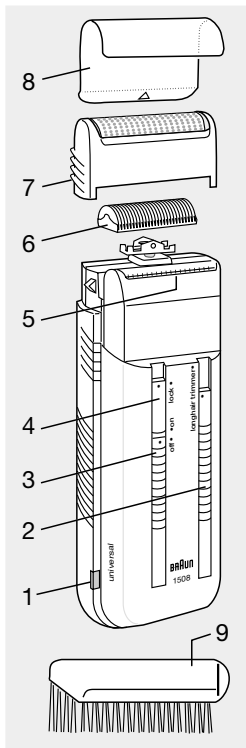

English

Our products are engineered to meet the highest standards of quality, functionality and design. We hope you thoroughly enjoy your new Braun appliance.

Specifications

Wattage 4 W

Voltage range «mains operation»

100 – 240 V \approx / 50 or 60 Hz

Voltage range «charging»

(for cordless operation)

12 – 240 V \approx / 50 or 60 Hz

The best environmental temperature range for the shaver is between + 15 °C to + 35 °C. The shaver should never be exposed to temperatures of less than 0 °C and more than + 40 °C for longer than a few hours.

Keep the shaver and mains lead dry at all times. Do not handle with wet hands. Do not store in a damp environment. To avoid damage do not wind the mains lead around the appliance. It is important to check the mains lead for damage periodically particularly at each end where the mains lead enters the plug.

Environmentally friendly cell unit

For environmental reasons this appliance is provided with a nickel-hybrid cell unit. This cell unit does not contain any poisonous heavy metals.



Nevertheless, in the interest of recycling raw materials please do not dispose of this appliance in the household waste at the end of its useful life.

Disposal can take place at a Braun Service Centre or at appropriate collection sites.

For easy recycling this shaver is equipped with a screw mechanism in the plug socket. This mechanism should only be activated at the end of the useful life of the shaver and should be carried out only by a Braun Service Centre.

Description

- ① Charging pilot light
- ② Longhair trimmer switch
- ③ On/off switch
- ④ Switch lock «lock»
- ⑤ Pop-out longhair trimmer
- ⑥ Cutter block
- ⑦ Shaving foil frame
- ⑧ Foil protection cap
- ⑨ Cleaning brush

Cordless shaving/charging

When charging the shaver for the first time, connect the shaver to the mains (100 – 240 V), via the mains lead, and charge with the switch ③ set at «off», until the charging pilot light ① goes off. The shaver should be discharged through normal shaving until it stops completely.

The shaver then should be recharged from the mains (100 – 240 V), until the pilot light ① goes off, with the switch ③ set at «off». This charging method preserves the life of the rechargeable cell unit. This and subsequent charges will take approximately 60 minutes (quick charge). The charging pilot light ① illuminates to show that the shaver is connected to the mains. When the rechargeable cell unit is fully charged, the charging pilot light goes off.

The shaver automatically adapts to all international direct and alternating current voltages (12 – 240 V ≈ / 50 or 60 Hz) and all frequencies. The shaver can also be recharged on voltages below international standards in cars and boats, etc. However, a minimum 12 V outlet (direct or alternating current) is required. Recharging this way takes approximately 20 hours, and requires a special charging cord.

The surrounding temperature should not be higher than + 25 °C when recharging at 12 V, to ensure the proper functioning of the shaver.

A full charge will give you approximately 35 minutes of cordless shaving.

Preserving the cell unit

In order to preserve the life of the cell unit, it should be fully discharged approximately once every 6 months by normal shaving and then fully recharged from the mains until the charging pilot light ① goes off.

This procedure will condition the rechargeable cell unit, giving you the best possible shaving performance and prolonging the life of the rechargeable cell unit.

The shaver should not be left in permanent charge for several weeks.

Shaving with the mains lead

If your shaver's rechargeable cell unit is flat (i.e. when you first use the shaver or the shaver runs out of power) you can connect the shaver directly to an outlet in order to shave immediately.

If the shaver should, however, not run immediately, leave it plugged in with switch ③ set to «off», for approximately 1 minute. Thereafter, you can shave with the mains lead plugged into the outlet.

Shaving directly via the special charging cord while connected to outlets below international standard voltages (e.g. cars, boats, etc.) is not possible.

Shaving

Remove the foil protection cap ⑧ (a). Push switch ③ up to «on». Hold the shaver at right angles to your skin. Stretch your skin with your free hand (b). Guide the shaver smoothly against the direction of beard growth, applying only gentle pressure.

Longhair trimming

To use pop-out longhair trimmer ⑤, push switch ② to setting «longhair trimmer». The longhair trimmer allows easy and exact trimming of the side burns (c). The longhair trimmer can be switched on and off during shaving.

Switching the shaver off

Push the on/off switch ③ back all the way to setting «off».

Important: After every shave replace the foil protection cap ⑧ on the foil frame ⑦.

Switch lock

To avoid accidentally switching on the shaver and discharging the cell unit, the switch lock should be turned on when travelling. Push switch ④ all the way down to the setting «lock».

Cleaning and maintenance

After every shave, remove the foil frame ⑦ (d) and tap out lightly. Brush out the cutter block ⑥ with the cleaning brush ⑨ (e). Do not clean the shaving foil with the cleaning brush ⑨ to avoid damaging it. Approximately every four weeks clean the space between the longhair trimmer ⑤ and the shaver with the cleaning brush ⑨.

Clean the cutter block ⑥ with Braun cleaning spray to maintain your shaver's top shaving performance and to keep it hygienic. After every cleaning replace the foil protection cap ⑧ on the foil frame ⑦.

Changing the shaving parts

The shaving foil frame ⑦ should be held at the two grooved surfaces and pulled off (d).

The cutter block ⑥ can be removed (e.g. for cleaning) by turning it at right angles to the shaver and lifting it off (f). To replace the cutter block, snap it onto the holding studs (g). Replace the new foil frame in the right direction (d) until it locks in place.

Important

Buy only original Braun spare parts, especially when replacing the mains lead or the shaving foil frame ⑦.

When buying a new shaving foil frame look for the **BRAUN** brand and the correct identification number «596» (h).

When looking to purchase a new Braun foil frame, ensure that you buy the right colour: a grey or black coloured frame.

Only this way you can be assured of a safe, close and efficient shave.

Parts for car or boat

When recharging your shaver in a car or boat use only the special Braun charging cord (No. 5-001-687) that is stated on the packaging for this purpose (available at your dealer or from a Braun Service Centre). Avoid direct sunlight on the shaver (see temperature range).

Subject to change without notice.



This product conforms to the EMC-Requirements as laid down by the Council Directive 89/336/EEC.

Guarantee

We grant 1 year guarantee on the product commencing on the date of purchase. Within the guarantee period we will eliminate, free of charge, any defects in the appliance resulting from faults in materials or workmanship, either by repairing or replacing the complete appliance as we may choose.

This guarantee extends to every country where this appliance is supplied by Braun or its appointed distributor.

This guarantee does not cover: damage due to improper use, normal wear or use as well as defects that have a negligible effect on the value or operation of the appliance. The guarantee becomes void if repairs are undertaken by unauthorised persons and if original Braun parts are not used.

To obtain service within the guarantee period, hand in or send the complete appliance with your sales receipt to an authorised Braun Customer Service Centre.

For UK only:

This guarantee in no way affects your rights under statutory law.